

MANUFACTURED HOUSING PARTS AND ACCESSORIES

L  
A  
N  
E

M

M<sup>o</sup>DUFF

THIRTY YEARS OF SERVICE EXCELLENCE

**LANE MCDUFF SALES COMPANY, INC.  
TERMS AND CONDITIONS**

- 1. NONPERFORMANCE:** Seller's nonperformance shall be excused where it's impossible to perform because of governmental interference, governmental regulations, strikes, and force majeure, or inability to perform with reasonable diligence.
- 2. CLAUSE LIMITING DAMAGES:** Buyer contractually agrees that it shall not be entitled to recover any damage against seller other than up to the cost of the goods on the invoice, buyer expressly agrees to write any incidental or consequential damages, loss of profit, costs, inconvenience, or other losses arising from the purchase of goods described in this invoice.
- 3. PLACE OF PERFORMANCE AND LAW:** Seller and buyer enter into this contract to sell/buy at seller's place of business; the law governing any dispute concerning the goods or this contract shall be governed by Texas law; and venue of any litigation between seller and buyer shall lie exclusively in (Tarrant County) Texas.
- 4. PAYMENT TERMS:** COD shipments are net, open accounts are 2% 10 days net 30 days or as otherwise quoted. If payment is not received by due date, a finance charge of 1.5% (or the maximum allowable in Texas) of the past due balance, will be added for each succeeding month, until payment is received. All payments will be made to Fort Worth, (Tarrant County) Texas.
- 5. TAXES:** Unless otherwise stated, prices quoted do not include City, County, State, MTA, Federal, or other taxes imposed on products or services offered by seller.
- 6. EXCLUSION OF WARRANTIES:** Seller makes no warranty, express or implied including warranty of merchantability, warranty of fitness for purpose, warranty of quality, in as much as all goods sold by this invoice are "as is" or "with all faults". If the manufacturer of goods described herein offers a warranty, the seller will notify buyer of such warranty which shall be exclusively with the manufacturer.
- 7. RETURNS:** Products shall not be returned by buyer without prior written acceptance by seller. The amount of credit, if any, shall be determined after a product inspection by seller. Seller will not accept the return of special order material. Returns are subject to 20% restocking charge.
- 8. DELIVERY:** Most orders will be delivered by Lane McDuff truck and F.O.B. your location. Where third party freight carriers are used to deliver materials, the seller's responsibility ceases upon delivery to third party carrier. Therefore claims for lost or damaged materials shall be made with third party carrier. Buyer bears the risk of loss for goods covered by this invoice/quotation from the time of their selection by seller, except where loss is caused by seller's willful conduct.
- 9. PRICING AND QUOTATIONS:** All pricing will remain firm for term stated in seller's quotation and price sheet, except in those circumstances where manufacturer recinds pricing due to raw material or other increases, which will be subject to change without notice or re-negotiation or quotes.

# Table of Contents

## HOME IMPROVEMENTS - Exterior

Skirting . . . . .	.2-7
Doors . . . . .	.8-21
Knobs & Locks . . . . .	.22
Hardware & Accessories . . . . .	.23
Windows . . . . .	.24-30

## HOME IMPROVEMENTS - Exterior II

Transport . . . . .	.31
Setup . . . . .	.32
Anchor . . . . .	.33-35
Steps . . . . .	.36

## HOME IMPROVEMENTS - Interior

Appliances . . . . .	.38-40
Plumbing . . . . .	.41-48
Carpets & Flooring . . . . .	.49
Lights & FixturesI . . . . .	.50
HVAC . . . . .	.51-52
Roofing . . . . .	.53
Molding . . . . .	.54-57

## HARDWARE - Miscellaneous

Tape/Screws . . . . .	.58
Sealants . . . . .	.59
Safety & Promotional Material . . . . .	.60

# Lane-McDuff Vinyl Skirting

At Lane-McDuff we are proud to offer Variform<sup>®</sup> vinyl skirting. Variform vinyl skirting features an unprecedented combination of strength, durability and appearance. This quality product is easy to install and even easier to maintain, plus you add beauty and value to your home. We understand that your home is an important investment, which is why we offer you the highest quality vinyl skirting in the industry in today's most popular styles and colors.

## Lane-McDuff Vinyl Skirting Features:

- Unique channel vent system that cleverly conceals the vents to only show the natural wood appearance
- Brings out the beauty of your home
- Easy maintenance... No Painting
- Unbending Strength... Superior rigidity provides maximum protection from blow-outs
- Manufacturer's Lifetime Limited Warranty

*The rich texture and character of woodgrain adds an elegant touch to any home.*

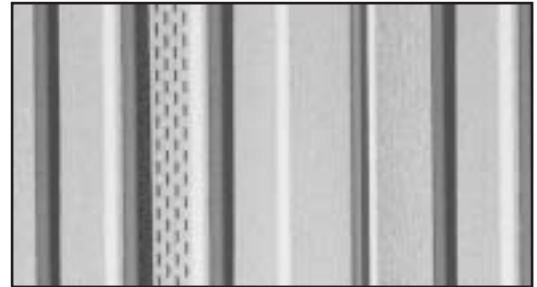

## FIGURING MATERIALS IS EASY!

- ✓ With a tape, measure the perimeter of the home, deck, or hot tub you wish to skirt, making sure to measure the entire perimeter, including bays and porches.
- ✓ The chart below shows some typical size homes and their corresponding linear measurements.
- ✓ To determine the average height, first measure the distance between the ground and the bottom of what you're skirting.
- ✓ Take this measurement at each of the corners and at the center of each side.
- ✓ Total all six of these measurements and divide by six to arrive at the average height. The worksheet at the right is helpful.
- ✓ Next, find that height in the chart below. Scan over to the point under the approximate linear footage of your project. That will be the number of skirting panels you will need to order.
- ✓ For the top rails, top back rails, and ground channels you'll need, look only in the column under the linear footage that come closest to your project.

Then gather your tools and begin the installation!

**SKIRTING MATERIALS WORKSHEET**

**Step One**  
Enter linear footage \_\_\_\_\_ ft. \_\_\_\_\_ in

**Step Two** — Enter actual height at each of four corners and total below.

Corner 1	_____ in
Corner 2	_____ in
Corner 3	_____ in
Corner 4	_____ in
TOTAL 1	_____ in

**Step Three** — Enter actual height at the corner of each side and total below.

Side 1	_____ in
Side 2	_____ in
TOTAL 2	_____ in

**Step Four** — Add Total 1 to Total 2.

TOTAL 3	_____ in
---------	----------

**Step Five** — Divide Total 3 by 6 and enter below.  
*This is the Average Height*

_____ in
----------

# Skirting Components

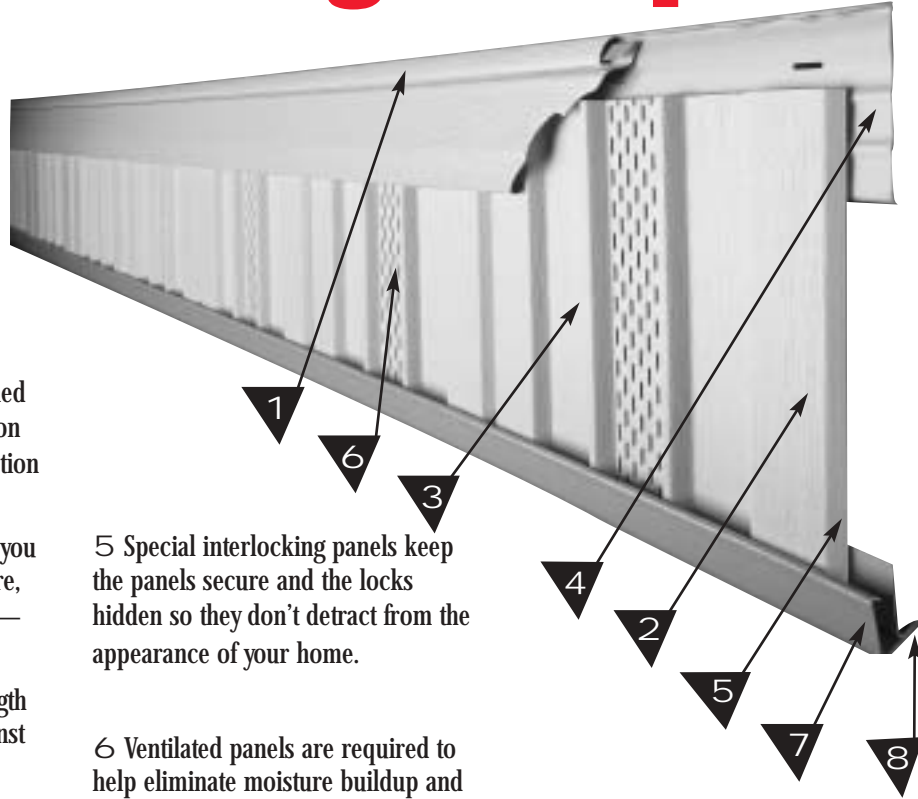

1 New top-rail design resists warping and blowout. Pre-notched front top rails allow for expansion overlap and help reduce installation time.

2 Removable-panel design lets you store garden tools, lawn furniture, and children's toys out of sight — but not out of reach.

3 New panel profile adds strength and provides extra security against wind loads. Extra-wide, 16-inch panels mean fewer panels to cut — which saves even more installation time.

4 Unique design lets panels self-adjust to ground-level fluctuations due to changes in weather conditions. These installation guides also keep panels from snagging on rail fasteners during frost heave, thereby preventing buckling.

5 Special interlocking panels keep the panels secure and the locks hidden so they don't detract from the appearance of your home.

6 Ventilated panels are required to help eliminate moisture buildup and allow for proper air circulation. (Check your home's specifications for proper ventilation requirements.)

7 "F" shaped bottom rail design (instead of a narrow "U" shaped channel) provides a stable foundation and prevents the channel from buckling.

8 And the bottom rail design, with its precut slots for ground spikes or cement screws, allows for ease of installation on concrete or directly on the ground.

*(Several different component colors are used in photos for enhancement purposes only).*

## MATERIALS CALCULATIONS

Size of Home	12' x					14' x				16' x				24' x			28' x		
	50'	55'	60'	65'	70'	60'	65'	70'	80'	60'	65'	70'	80'	60'	65'	70'	65'	70'	
Perimeter (linear measurement)	120'	130'	140'	150'	160'	44'	158'	162'	182'	148'	162'	166'	188'	154'	174'	180'	182'	192'	
Height of Skirting (Panel Cut Length)	<b>NUMBER OF PANELS REQUIRED</b>																		
16" - 18"	12	13	14	15	15	14	15	16	18	14	16	16	19	16	17	18	18	18	
19" - 20"	13	14	15	17	18	16	17	18	20	16	18	18	21	18	19	20	20	21	
21" - 24"	15	17	18	19	20	18	20	21	23	19	21	21	25	21	22	23	23	24	
25" - 28"	18	20	21	23	24	22	24	25	28	23	25	25	28	25	27	27	28	29	
29" - 36"	23	25	27	29	30	27	30	31	35	28	31	32	36	31	33	35	35	36	
37" - 48"	30	33	35	38	40	36	40	41	46	37	41	42	48	41	44	46	46	48	
Rails (# of pcs)	11	12	13	13	14	11	14	14	16	13	14	15	18	15	16	16	16	17	

# Skirting - Installation



- 1 Use a plumb bob to find the points on the ground exactly under the corners of your home. Connect the points with a chalk line. Align ground channel over chalk line. Then use ground spikes to fasten the skirting's ground channel along the chalk lines.



- 3 Working in a straight line along the bottom of your home, nail the top back rail onto the home all around.



- 5 Snap the top front rail into the top back rail and you're finished.



- 2 To go around corners, just notch, bend the ground channels, and attach them to the ground. Don't cut completely through them.



- 4 Cut panels to height you need, angling them on bottom to correspond to ground angle. With snap-lock tool, punch tabs every 4" along both top and bottom of edges of cut panel sections. Be sure to punch so that tabs extend outward to catch on rail. Interlock several panels at a time, then set them into ground channel. At corners, just bend panels; they're flexible. Don't cut them.

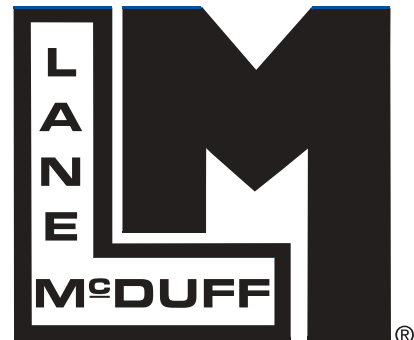

# Skirting

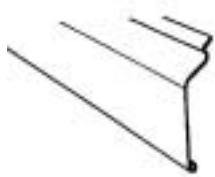

Top Trim Front



Top Mount



Vinyl Ground Channel



B-6651 Ground Spikes (125/PKG.)



Screws

## Lane-McDuff Trim Kits

- B-66010** L-M GREY TRIM KIT (14/CTN.)
- B-66030** L-M WHITE TRIM KIT (14/CTN.)
- B-66040** L-M BEIGE TRIM KIT (14/CTN.)
- B-66050** L-M TAN TRIM KIT (14/CTN.)
- B-66060** L-M ISLAND PEARL T.K.(14/CTN)
- B-66070** L-M CLAY TRIM KIT (14/CTN)

## All Trim Kits Include:

- 14 Top Trim Fronts - 11.5'
- 14 Top Trim Mounts - 11.5'
- 14 Ground Channels - 11.5'
- Spikes - 7" (100/ Pkg.)
- Screws - 3/4" (100 Pkg.)

Ctn. Qty 12 pcs 16" width x 12' long

## Lane-McDuff Trim & Panels

- B-66011** L-M GREY TOP TRIM MOUNT
- B-66012** L-M GREY TOP TRIM FRONT
- B-66013** L-M GREY GROUND CHANNEL
- B-66016** L-M GREY SINGLE PANEL
- B-66031** L-M WHITE TOP TRIM MOUNT
- B-66032** L-M WHITE TOP TRIM FRONT
- B-66033** L-M WHITE GROUND CHANNEL
- B-66036** L-M WHITE SINGLE PANEL
- B-66041** L-M BEIGE TOP TRIM MOUNT
- B-66042** L-M BEIGE TOP TRIM FRONT
- B-66043** L-M BEIGE GROUND CHANNEL
- B-66046** L-M BEIGE SINGLE PANEL
- B-66051** L-M TAN TOP TRIM MOUNT
- B-66052** L-M TAN TOP TRIM FRONT
- B-66053** L-M TAN GROUND CHANNEL
- B-66056** L-M TAN SINGLE PANEL
- B-66058** L-M TAN PANELS (12/CTN.)
- B-66061** L-M ISLAND PEARL TOP T.MOUNT
- B-66062** L-M ISLAND PEARL TOP T.FRONT
- B-66063** L-M ISLAND PEARL GROUND CHANNEL

- B-66066** L-M ISLAND PEARL SINGLE PANEL
- B-66071** L-M CLAY TOP TRIM MOUNT
- B-66072** L-M CLAY TOP TRIM FRONT
- B-66073** L-M CLAY GROUND CHANNEL
- B-66076** L-M CLAY SINGLE PANEL

## Lane-McDuff Special Order Panels

- B-66014** L-M SOLID GREY SINGLE PANEL
- B-66034** L-M SOLID WHITE SINGLE PANEL
- B-66044** L-M SOLID BEIGE SINGLE PANEL
- B-66054** L-M SOLID TAN SINGLE PANEL
- B-66064** L-M SOLID ISLAND PEARL SINGLE PANEL
- B-66074** L-M SOLID CLAY SINGLE PANEL

# Rock Vinyl Skirting



## Metal Screws

**B-6719**

500/CTN.BLK.SCREW  
F/ ROCK SKIRT

**B-6719-S**

500/CTN.SAND SCREW  
F/ ROCK SKIRT

## Rails

**B-6716** 12' EVER ROCK BOTTOM RAIL

**B-6716-S** 12' SAND EVER ROCK BOTTOM RAIL

## Ever Rock Vent Insert

**B-6717**  
EVER ROCK VENT INSERT

**B-6717-S**  
SAND EVER ROCK VENT  
INSERT

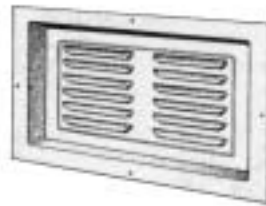

Front View

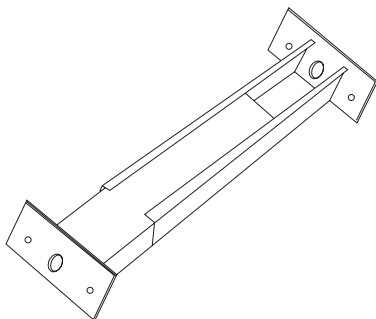

## Steel Studs

**B-66500** 12" to 40" ADJ. SKIRTING STUD

**B-66510** 40" to 72" ADJ. SKIRTING STUD

## Ever Rock Skirting Panels

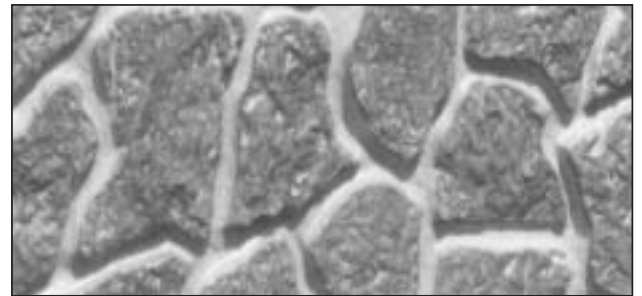

**5' Panel**  
**B-6718**

## Access Door Kit

32" x 36" ACCESS DOOR KIT  
IN BROWN, GRAY & SAND

## 5' Panels

**B-6700** 30" BROWN EVER ROCK PANEL

**B-6701** 36" BROWN EVER ROCK PANEL

**B-6702** 48" BROWN EVER ROCK PANEL

**B-6703** 30" GRAY EVER ROCK PANEL

**B-6704** 36" GRAY EVER ROCK PANEL

**B-6705** 48" GRAY EVER ROCK PANEL

**B-6706** 30" SAND EVER ROCK PANEL

**B-6707** 36" SAND EVER ROCK PANEL

**B-6708** 48" SAND EVER ROCK PANEL

*Limited Lifetime Warranty on Vinyl.  
5-Year Warranty on Paint. This  
product is also flame retardant.*

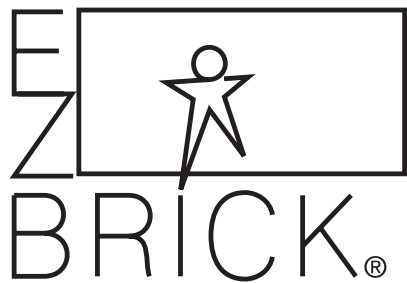

# EZ-Brick Skirting



## EZ-BRICK SKIRTING PANELS

- B-6670 32"H X 36"W WHITE BRICK SKIRT.
- B-6671 32"H X 36"W TAN BRICK SKIRT.
- B-6672 32"H X 36"W GREY BRICK SKIRT.
- B-6673 32"H X 36"W CLAY BRICK SKIRT.
- B-6674 32"H X 36"W RED BRICK SKIRT.
- B-6675 40"H X 24"W WHITE BRICK SKIRT.
- B-6676 40"H X 24"W TAN BRICK SKIRT.
- B-6677 40"H X 24"W GREY BRICK SKIRT.
- B-6678 40"H X 24"W CLAY BRICK SKIRT.
- B-6679 40"H X 24"W RED BRICK SKIRT.

## EZ-BRICK DIVIDERS & SPACERS

- B-6680-C 5" X 40" CLAY DIVIDER OR SPACER
- B-6680-G 5" X 40" GREY DIVIDER OR SPACER
- B-6680-R 5" X 40" RED DIVIDER OR SPACER
- B-6680-T 5" X 40" TAN DIVIDER OR SPACER
- B-6680-W 5" X 40" WHITE DIVIDER OR SPACER

## EZ-BRICK INSIDE CORNERS

- B-6683-C CLAY INSIDE CORNER
- B-6683-G GREY INSIDE CORNER
- B-6683-R RED INSIDE CORNER
- B-6683-T TAN INSIDE CORNER
- B-6683-W WHITE INSIDE CORNER

## EZ-BRICK OUTSIDE CORNERS

- B-6682-C CLAY OUTSIDE CORNER
- B-6682-G GREY OUTSIDE CORNER
- B-6682-R RED OUTSIDE CORNER
- B-6682-T TAN OUTSIDE CORNER
- B-6682-W WHITE OUTSIDE CORNER

At Lane-McDuff we are proud to offer EZ-Brick skirting. E-Z Brick skirting features an unprecedented combination of strength, durability and appearance. This quality product is easy to install and features a patent pending snap and lock system that greatly increases the strength of the panels when securley snapped and locked together. We understand that your home is an important investment, which is why we offer you the highest quality skirting products in the industry in today's most popular styles and colors.

# Doors - Extruded

## Blank Doors

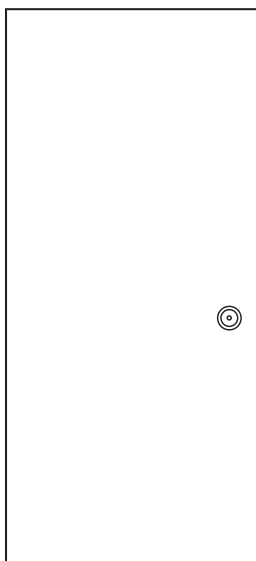

**STANDARD DOOR**- Wood  
Inside and Outside

**ECONOMY DOOR** - has  
a fiberglass skin. Please  
specify **RIGHT HAND** or **LEFT  
HAND** when ordering.

Looking at the door from  
outside the home, the hinge  
side designates door type.

\*B-6300 28 X 72 BLANK DOOR

- \*B-6301 30 X 74 BLANK DOOR
- \*B-6301-LH 30 X 74 L.H. BLANK DOOR
- \*B-6301-RH 30 X 74 R.H. BLANK DOOR
- \*B-6302 30 X 78 BLANK DOOR
- \*B-6302-LH 30 X 78 L.H. BLANK DOOR
- \*B-6302-RH 30 X 78 R.H. BLANK DOOR
- \*B-6303-LH 42 X80 L.H. BLANK DOOR
- \*B-6303-LHE 42 X80 L.H. ECON BLANK DOOR
- \*B-6303-RH 42 X80 R.H. BLANK DOOR
- \*B-6303-RHE 42 X80 R.H. ECON BLANK DOOR
- \*B-6304-LH 48 X 80 L.H. BLANK DOOR
- \*B-6304-LHE 48 X 80 L.H. ECON. BLANK DOOR
- \*B-6304-RH 48 X 80 R.H. BLANK DOOR
- \*B-6304-RHE 48 X 80 R.H. ECON. BLANK DOOR
- \*B-6312-LH 30 X 76 L.H.BLANK DOOR
- \*B-6312-LHE 30 X 76 LH ECON BLANK DOOR
- \*B-6312-RH 30 X 76 RH BLACK DOOR
- \*B-6312-RHE 30 X 76 R.H. ECON BLANK DOOR
- \*B-6320-LH 38 X 80 L.H. BLANK DOOR
- \*B-6320-LHE 38 X 80 L.H. ECON. BLANK DOOR
- \*B-6320-RH 38 X 80 R.H. BLANK DOOR
- \*B-6320-RHE 38 X 80 R.H. ECON. BLANK DOOR
- \*B-6323-LH 38 X 78 L.H. BLANK DOOR
- \*B-6323-RH 38 X 78 R.H. BLANK DOOR
- \*B-6325-LH 30 X 80 L.H. BLANK DOOR
- \*B-6325-LHE 30 X 80 L.H. ECON. BLANK DOOR
- \*B-6325-RH 30 X 80 R.H.BLANK DOOR
- \*B-6325-RHE 30 X 80 R.H. ECON. BLANK DOOR
- B-6330-LH 36 X 80 L.H. BLANK DOOR
- B-6330-LHE 36 X 80 L.H. ECON. BLANK DOOR
- B-6330-RH 36 X 80 R.H. BLANK DOOR
- B-6330-RHE 36 X 80 R.H. ECON. BLANK DOOR
- \*B-6333-LH 32 X 74 L.H. ECON. BLANK DOOR
- \*B-6333-LHE 32 X 74 L.H. ECON. BLANK DOOR

- \*B-6333-RH 32 X 74 R.H. ECON. BLANK DOOR
- \*B-6333-RHE 32 X 74 RH ECON. BLANK DOOR
- \*B-6334-LH 32 X 80 L.H. BLANK DOOR
- \*B-6334-LHE 32 X 80 L.H. ECON. BLANK DOOR
- \*B-6334-RH 32 X 80 R.H. ECON. BLANK DOOR
- \*B-6334-RHE 32 X 80 R.H. ECON. BLANK DOOR
- \*B-6335-LH 30 X 72 L.H. BLANK DOOR
- \*B-6335-LHE 30X72 L.H. ECON. BLANK DOOR
- \*B-6335-RH 30X72 R.H. BLANK DOOR
- \*B-6335-RHE 30X72 R.H. ECON. BLANK DOOR
- B-6337-LH 32 X 72 L.H. BLANK DOOR
- B-6337-LHE 32 X72 L.H. ECON. BLANK DOOR
- B-6337-RH 32 X 72 R.H. BLANK DOOR
- B-6337-RHE 32 X 72 R.H. ECON. BLANK DOOR
- B-6343-LH 32 X 78 L.H. BLANK DOOR
- B-6343-LHE 32 X 78 L.H. ECON. BLANK DOOR
- B-6343-RH 32 X 78 R.H. BLANK DOOR
- B-6343-RHE 32 X 78 R.H. ECON. BLANK DOOR
- B-6344-LH 34 X 78 L.H.BLANK DOOR
- B-6344-LHE 34 X 78 L.H. ECON. BLANK DOOR
- B-6344-RH 34 X 78 R.H. BLANK DOOR
- B-6344-RHE 34 X 78 R.H. ECON. BLANK DOOR
- \*B-6347-LH 34 X 74 L.H. BLANK DOOR
- \*B-6347-LHE 34 X74 L.H. ECON. BLANK DOOR
- \*B-6347-RH 34 X 74 R.H. BLANK DOOR
- \*B-6347-RHE 34 X 74 R.H. ECON. BLANK DOOR
- \*B-6348-LH 34 X 80 L.H. BLANK DOOR
- \*B-6348-LHE 34 X 80 L.H. ECON. BLANK DOOR
- \*B-6348-RH 34 X 80 R.H. BLANK DOOR
- \*B-6348-RHE 34 X 80 R.H. ECON. BLANK DOOR
- B-6350-LH 32 X 76 L.H.BLANK DOOR
- B-6350-LHE 32 X 76 L.H. ECON. BLANK DOOR
- B-6350-RH 32 X 76 R.H. ECON. BLANK DOOR
- B-6350-RHE 32 X 76 R.H. ECON. BLANK DOOR
- B-6355-LH 34 X 76 L.H. BLANK DOOR
- B-6355-LHE 34 X 76 L.H. ECON. BLANK DOOR
- B-6355-RH 34 X 76 R.H. BLANK DOOR
- B-6355-RHE 34 X 76 R.H. ECON. BLANK DOOR
- \*B-6358-LH 36 X 78 L.H. BLANK DOOR
- \*B-6358-LHE 36 X 78 L.H. ECON. BLANK DOOR
- \*B-6358-RH 36 X 78 R.H. BLANK DOOR
- \*B-6358-RHE 36 X 78 R.H. ECON. BLANK DOOR
- \*B-6378 36 X 76 BLANK DOOR
- \*B-6378-LH 36 X 76 L.H. BLANK DOOR
- \*B-6378-RH 36 X 76 R.H. BLANK DOOR

# Doors - Extruded



## 4 x 24 Window - Pre-Hung

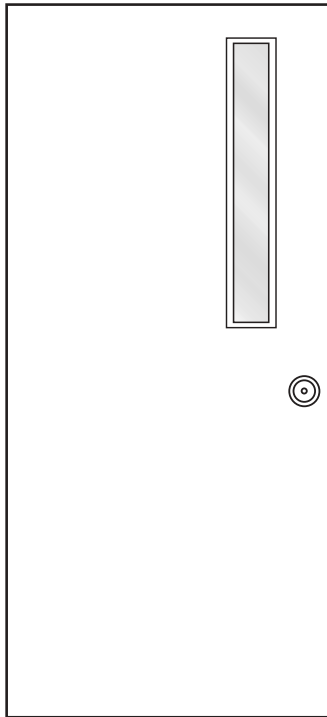

<b>B-6321-LH</b>	32X80 L.H.DOOR W/4 X 24 WINDOW
<b>B-6321-RH</b>	32X80 R.H.DOOR W/4 X 24 WINDOW
<b>B-6322-LH</b>	32X78 L.H.DOOR W/4 X 24 WINDOW
<b>B-6322-RH</b>	32X78 R.H.DOOR W/4 X 24 WINDOW
<b>B-6326-LH</b>	34X80 L.H.DOOR W/4 X 24 WINDOW
<b>B-6326-RH</b>	34X80 R.H.DOOR W/4 X 24 WINDOW
<b>B-6331-LH</b>	36X80 L.H.DOOR W/4 X 24 WINDOW
<b>B-6331-RH</b>	36X80 R.H.DOOR W/4 X 24 WINDOW
<b>B-6338-LH</b>	32X72 L.H.DOOR W/4 X 24 WINDOW
<b>B-6338-RH</b>	32X72 R.H.DOOR W/4 X 24 WINDOW
<b>B-6346-LH</b>	32X74 L.H.DOOR W/4 X 24 WINDOW
<b>B-6346-RH</b>	32X74 R.H.DOOR W/4 X 24 WINDOW
<b>B-6351-LH</b>	32X76 L.H.DOOR W/4 X 24 WINDOW
<b>B-6351-RH</b>	32X76 R.H.DOOR W/4 X 24 WINDOW
<b>B-6356-LH</b>	34X76 L.H.DOOR W/4 X 24 WINDOW
<b>B-6356-RH</b>	34X76 R.H. DOOR W/4 X 24 WINDOW
<b>B-6365-LH</b>	30 X 76 L.H. DOOR W/4X24 WINDOW
<b>B-6365-RH</b>	30 X 76 R.H. DOOR W/4X24 WINDOW

Wood Inside and Outside.  
Specify LH and RH when ordering.

## 10 x 10 Window - Pre-Hung

<b>B-63144-LHE</b>	34X78 LH ECON DR W10X10 WIND
<b>B-63144-RHE</b>	34X78 RH ECON DR.W10/10 WIND
<b>B-6321-LHE</b>	32X80 LH ECON DR W/10X10 WIND
<b>B-6321-RHE</b>	32X80 RH ECON DR W/10X10 WIND
<b>B-6322-LHE</b>	32X78 LH ECON DR W/10X10 WIND
<b>B-6322-RHE</b>	32X78 RH ECON DR W/10X10 WIND
<b>B-6326-LHE</b>	34X80 LH ECON DR W/10X10 WIND
<b>B-6326-RHE</b>	34X80 RH ECON DR W/10X10 WIND
<b>B-6331-LHE</b>	36X80 LH ECON DR W/10X10 WIND
<b>B-6331-RHE</b>	36X80 RH ECON DR W/10X10 WIND
<b>B-6338-LHE</b>	32X72 LH ECON W/10X10 WINDOW
<b>B-6338-RHE</b>	32X72 RH ECON DR W/10X10 WIND
<b>B-6346-LHE</b>	32X74 ECON LH DR W/10X10 WIND
<b>B-6346-RHE</b>	32X74 ECON RH DR W/10X10 WIND
<b>B-6351-LHE</b>	32X76 LH ECON DR W/10X10 WIND
<b>B-6351-RHE</b>	32X76 RH ECON DR W/10X10 WIND
<b>B-6356-LHE</b>	34X76 LH ECON DR 10X10 WINDOW
<b>B-6356-RHE</b>	34X76 RH ECON DR 10X10 WINDOW

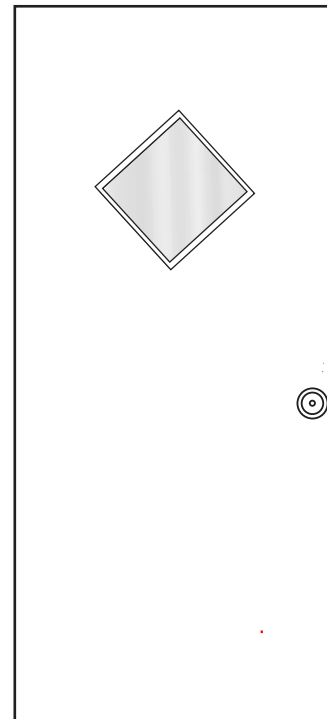

Economy Doors have have a fiberglass skin.  
All doors may not be stocked at all locations. Call for availability.

## Slider Window - Pre-Hung

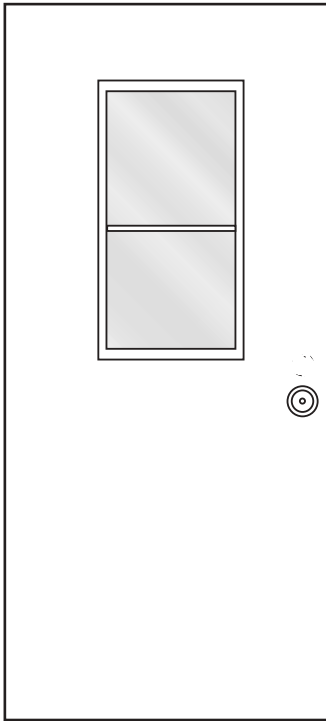

<b>B-6314-LH</b>	34 X 80 L.H. SLIDER DOOR
<b>B-6314-RH</b>	34 X 80 R.H. SLIDER DOOR
<b>B-6324-LH</b>	36X76 L.H.DOOR W/SLIDER WINDOW
<b>B-6324-RH</b>	36X76 R.H.DOOR W/SLIDER WINDOW
<b>B-63244-LHE</b>	34X78 LH ECON DR W/SLIDER WIND
<b>B-63244-RHE</b>	34X78 RH ECON DR W/SLIDER WIND
<b>B-63246-LHE</b>	32X74 LH ECON DR W/SLIDER WIND
<b>B-63246-RHE</b>	32X74 RH ECON DR W/SLIDER WIND
<b>B-6327-LH</b>	36X80 L.H.DOOR W/SLIDER WINDOW
<b>B-6327-LHE</b>	36X80 LH ECON DR W/SLIDER WIND
<b>B-6327-RH</b>	36X80 R.H.DOOR W/SLIDER WINDOW
<b>B-6327-RHE</b>	36X80 RH ECON DR W/SLIDER WIND
<b>B-6336-LH</b>	30X72 L.H.DOOR W/SLIDER WINDOW
<b>B-6336-LHE</b>	30X72 LH ECON DRW/SLIDER WIND
<b>B-6336-RH</b>	30X72 R.H.DOOR W/SLIDER WINDOW
<b>B-6336-RHE</b>	30X72 R.H.DOOR W/SLIDER WINDOW
<b>B-6339-LH</b>	32X72 L.H.DOOR W/SLIDER WINDOW
<b>B-6339-LHE</b>	32X72 LH.ECON DR /SLIDER WIND
<b>B-6339-RH</b>	32X72 R.H.DOOR W/SLIDER WINDOW
<b>B-6339-RHE</b>	32X72 RH ECON DR W/SLIDER WIND
<b>B-6349-LH</b>	32 X 80 L.H. SLIDER DOOR
<b>B-6349-LHE</b>	32X80 LH ECON SLIDER DR
<b>B-6349-RH</b>	32 X 80 R.H. SLIDER DOOR
<b>B-6349-RHE</b>	32X80 RH ECON SLIDER DR
<b>B-6352-LH</b>	32X76 L.H.DOOR W/SLIDER WINDOW
<b>B-6352-LHE</b>	32X76 LH ECON DR.W/SLIDER WIN
<b>B-6352-RH</b>	32X76 R.H.DOOR W/SLIDER WINDOW
<b>B-6352-RHE</b>	32X76 RH ECON DR W/SLIDER WIND
<b>B-6353-LH</b>	32X78 L.H.DOOR W/SLIDER WINDOW
<b>B-6353-LHE</b>	32X78 LH ECON DR W/SLIDER WIND
<b>B-6353-RH</b>	32X78 R.H.DOOR W/SLIDER WINDOW
<b>B-6353-RHE</b>	32X78 RH ECON DR W/SLIDER WIND
<b>B-6357-LH</b>	34X76 L.H.DOOR W/SLIDER WINDOW
<b>B-6357-LHE</b>	34X76 LH ECON DR W/SLIDER WIN
<b>B-6357-RH</b>	34X76 R.H.DOOR W/SLIDER WINDOW
<b>B-6357-RHE</b>	34X76 RH ECON DR W/SLIDER WIN
<b>B-6360-LH</b>	34X74 L.H.DOOR W/SLIDER WINDOW
<b>B-6360-RH</b>	34X74 R.H.DOOR W/SLIDER WINDOW
<b>B-63651-LH</b>	30 X 76 L.H.DR.W/SLIDER WINDOW
<b>B-63651-RH</b>	30 X 76 R.H.DR.W/SLIDER WINDOW

### Standard Door

Wood Inside and Outside

### Economy Door

Fiberglass Skin

Specify LH and RH when ordering.

\*Looking at the door from outside the home, the hinge side designates door type.

### How to Measure Doors:

Measure from door jam to door jam for width.

Measure from floor to stud for height.

All doors may not be stocked at all locations. Call for availability.

# Doors - Extruded



## Diamond Cottage Window - Pre-Hung

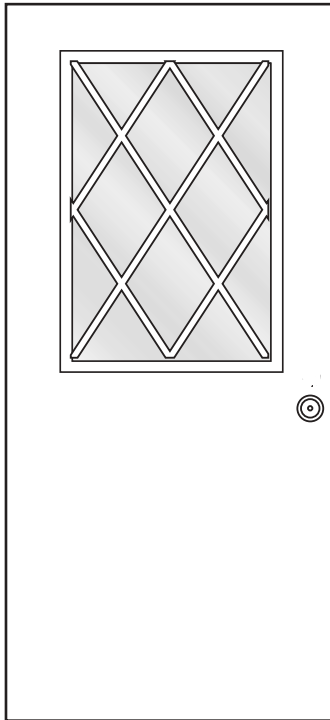

B-6313-LHC	32X78 L.H. COTTAGE DR
B-6313-LHCE	32X78 L.H. ECON COTTAGE DR.
B-6318-LHC	32X72 L.H. COTTAGE DR
B-6318-LHCE	32X72 L.H. ECON COTTAGE DR.
B-6318-RHC	32 X 72 R.H. COTTAGE DOOR
B-6318-RHCE	32X72 R.H. ECON COTTAGE DR.
B-6319-LHC	38 X 80 L.H. COTTAGE DOOR
B-6319-RHC	38 X 80 R.H. COTTAGE DOOR
B-6328-LHC	32 X 76 L.H. COTTAGE DOOR
B-6328-LHCE	32X76 LH ECON COTTAGE DR.
B-6328-RHC	32 X 76 R.H. COTTAGE DOOR
B-6328-RHCE	32X76 RH ECON COTTAGE DR.
B-63333-LHCE	32X74 LH ECON DRW/COTTAGE WIND
B-63333-RHCE	32X74 RH ECON DRW.COTTAGE WIND
B-63334-LHCE	32X80 LH ECON DRW/COTTAGE WIND
B-63334-RHCE	32X80 RH ECON DRW/COTTAGE WIND
B-63344-LHCE	34X78 LH ECON DRW/COTTAGE WIND
B-63344-RHCE	34X78 RH ECON DRW/COTTAGE WIND
B-6364-LHC	34 X 76 L.H. COTTAGE DOOR
B-6364-LHCE	34X76 LH ECON COTTAGE DR
B-6364-RHC	34 X 76 R.H. COTTAGE DOOR
B-6364-RHCE	34X76 RH ECON COTTAGE DR
B-6366-LHC	34 X 80 L.H. COTTAGE DOOR
B-6366-RHC	34 X 80 R.H. COTTAGE DOOR
B-6367-LHC	36 X 76 L.H. COTTAGE DOOR
B-6367-RHC	36 X 76 R.H. COTTAGE DOOR

### Standard Door

Wood Inside and Outside

### Economy Door

Fiberglass Skin

Specify LH and RH when ordering.

\*Looking at the door from outside the home, the hinge side designates door type.

### How to Measure Doors:

Measure from door jam to door jam for width.

Measure from floor to stud for height.

All doors may not be stocked at all locations. Call for availability.

# Doors - House Type



## Blank Door

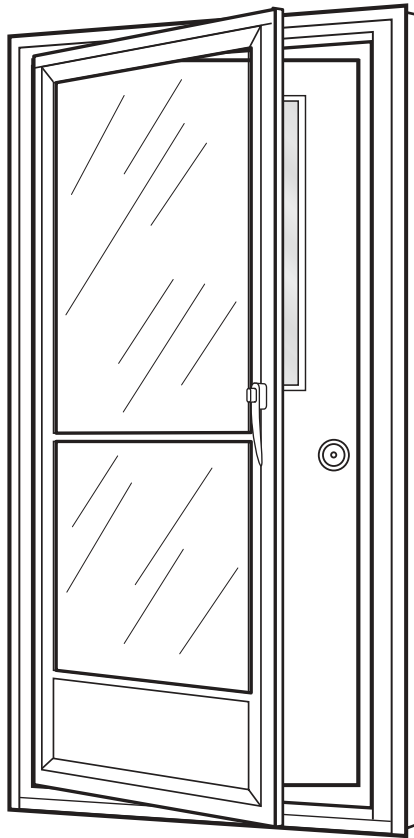

House-Type Door comes with New Door Lock and Hardware Kit.

B-6332-BLH	38X80LH HT W/K.V./DB STORM
B-6332-BLHW	38X80LH HT W/K.V./DB WH.STORM
B-6332-BRH	38X80RH HT W/K.V./DB STORM
B-6332-BRHW	38X80RH HT W/K.V./DB WH.STORM
B-6340-BLH	32X72LH HT W/K.V./DB STORM
B-6340-BLHW	32X72LH HT W/K.V./DB WH.STORM
B-6340-BRH	32X72 RH HT W/K.V./DB STORM
B-6340-BRHW	32X72RH HT W/K.V./DB WH.STORM
B-6341-BLH	32X78 LH HT W/K.V./DB STORM
B-6341-BLHW	32X78LH HT W/K.V./DB WH. STORM
B-6341-BRH	32X78 RH HT W/K.V./DB STORM
B-6341-BRHW	32X78RH HT W/K.V./DB WH. STORM
B-6342-BLH	36X80 LH HT W/K.V./DB STORM
B-6342-BLHW	36X80LH HT W/K.V./DB WH. STORM
B-6342-BRH	36X80 RH HT W/K.V./DB STORM
B-6342-BRHW	36X80RH HT W/K.V./DB WH. STORM
B-6354-BLH	32X76 LH HT W/K.V./DB STORM
B-6354-BLHW	32X76LH HT W/K.V./DB WH. STORM
B-6354-BRH	32X76 RH HT W/K.V./DB STORM
B-6354-BRHW	32X76RH HT W/K.V./DB WH. STORM
B-6359-BLH	34X76 LH HT W/K.V./DB STORM
B-6359-BLHW	34X76LH HT W/K.V./DB WH. STORM
B-6359-BRH	34X76 RH HT W/K.V./DB STORM
B-6359-BRHW	34X78RH HT W/K.V./DB WH. STORM
B-6361-BLH	34X78 LH HT W/K.V./DB STORM
B-6361-BLHW	34X78 LH HT W/K.V./DB WH. STRM
B-6361-BRH	34X78 RH HT W/K.V./DB STORM
B-6361-BRHW	34X78RH HT W/K.V./DB WH. STORM
B-6362-BLH	34X80 LH HT W/K.V./DB STORM
B-6362-BLHW	34X80LH HT W/K.V./DB.WH. STORM
B-6362-BRH	34X80 RH HT W/K.V./DB STORM
B-6362-BRHW	34X80RH HT W/K.,V./DB WH. STRM

Specify LH and RH when ordering.

How to Measure Doors:

Measure from door jam to door jam for width.

Measure from floor to stud for height.

All doors may not be stocked at all locations. Call for availability.

## Door with 4 x 24 Window

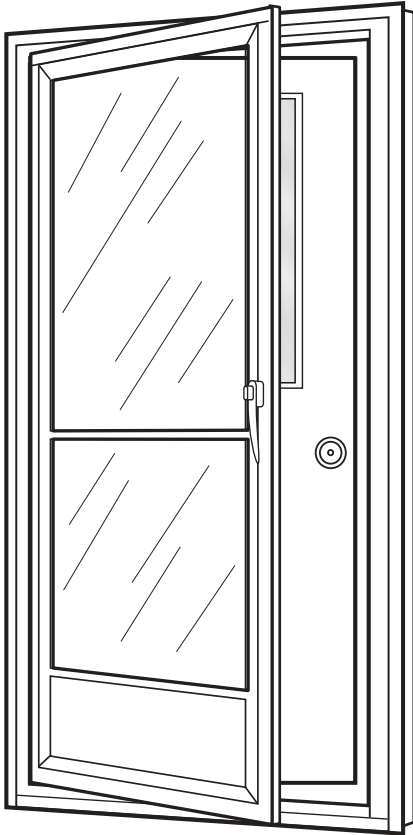

**STANDARD DOOR**- Wood  
Inside and Outside

**ECONOMY DOOR** - has  
a fiberglass skin with a 10x10  
window. Please specify  
RIGHT HAND or LEFT  
HAND when ordering.

Looking at the door from  
outside the home, the hinge  
side designates door type.

B-6329-LH	36X78 HO.TYPE L.H.W/STORM DOOR
B-6329-LH-W	36X78 HT L.H.W/WH. STORM
B-6329-LHE	34X78 ECON HO TYPE LH W/ST DR
B-6329-RH	36X78 HO.TYPE R.H.W/STORM DOOR
B-6329-RH-W	36X78 HT R.H.W/WH. STORM
B-6329-RHE	34X78 ECON HO.TYPE RH W/ST DR
B-6332-LH	38X80 HO.TYPE L.H.W/STORM DR
B-6332-LH-W	38X80 HT L.H.W/WH.STORM
B-6332-LHE	38X80 ECON HO TYPE LH W/STORM
B-6332-RH	38X80 HO.TYPE R.H.W/STORM DOOR
B-6332-RH-W	38X80 HT R.H.W/WH.STORM
B-6332-RHE	38X80 ECON HO TYPE RH W/STORM
B-6340-LH	32X72 L.H.HO.TYPE W/STORM DOOR
B-6340-LH-W	32X72 HTLH ECON DRW/ WH.STORM
B-6340-LHE	32X72 HTLH ECON DRW/ WH.STORM
B-6340-LHWE	32X72 LH ECON HT DR.W/10X10
B-6340-RH	32X72 HTLH ECON DRW/WH STORM
B-6340-RH-W	32X72 R.H.HO.TYPE W/STORM DOOR
B-6340-RHE	32X72 HT R.H.W/WH.STORM
B-6340-RHE	32X72 HT RH ECON DRW/WH. STORM
B-6340-RHWE	32X72 RH ECON HT DR.W10X10
B-6341-LH	32X72 HT RH ECON DR W/WH STORM
B-6341-LH-W	32 X 78 L.H. H.T. W/STORM DOOR
B-6341-LHWE	32X78 HT L.H.W/WH.STORM
B-6341-RH	32X78 HT L.H. ECON W/WH STORM
B-6341-RH-W	32 X 78 R.H. H.T. W/STORM DOOR
B-6341-RHWE	32X78 HT R.H.W/WH.STORM
B-6342-LH	32X78 HT R.H. ECON W/WH STORM
B-6342-LH-W	36 X 80 L.H. H.T. W/STORM DOOR
B-6342-LHE	36X80 HT L.H.W/WH.STORM
B-6342-RH	36X80 LH ECON HT W/STORM DR
B-6342-RH-W	36 X 80 R.H. H.T. W/STORM DOOR
B-6342-RHE	36X80 HT R.H.W/WH.STORM
B-6345-LH	36X80 RH ECON HT W/STORM DR
B-6345-LH-W	32 X 74 H.T. L.H. W/STORM DOOR
B-6345-LHE	32X74 HT L.H.W/WH.STORM
B-6345-LHWE	32X74 HT LH ECON W/STORM DR.
B-6345-RH	32X74 ECON HT LH W/WHITE STORM
B-6345-RH-W	32 X 74 H.T. R.H. W/STORM DOOR
B-6345-RHE	32X74 HT R.H.W/WH.STORM
B-6345-RHWE	32X74 HT ECON RH W/STORM DR
B-6354-LHE	32X74 ECON HT RH W/WHITE STORM
B-6354-LHWE	32X76 LH ECON HT DOOR W/STORM
	32X76LH ECON HTW/1010 WH.STORM

All doors may not be stocked at all locations. Call for availability.

# Doors - House Type



## Door with 4 x 24 Window

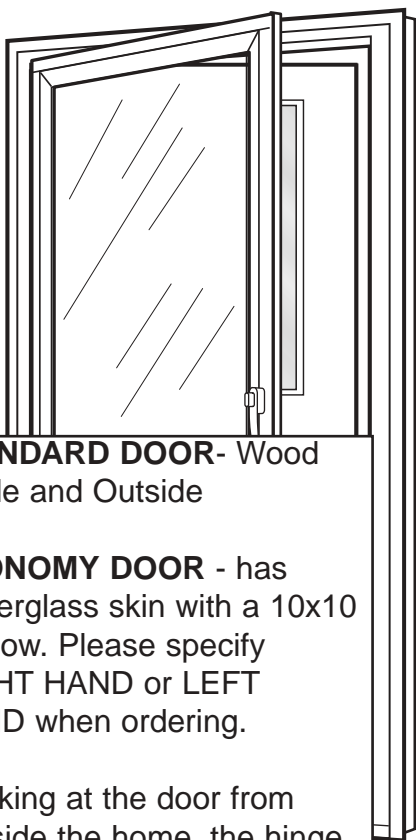

**STANDARD DOOR** - Wood  
Inside and Outside

**ECONOMY DOOR** - has  
a fiberglass skin with a 10x10  
window. Please specify  
RIGHT HAND or LEFT  
HAND when ordering.

Looking at the door from  
outside the home, the hinge  
side designates door type.

B-6354-RH	32X76 R.H.HO.TYPE W/STORM DOOR
B-6354-RH-W	32X76 HT R.H.W/WH.STORM
B-6354-RHE	32X76 RH ECON HT DR W/STORM
B-6354-RHWE	32X76 RH ECON HT 10X10 WH ST
B-6359-LH	34X76 L.H.HO.TYPE W/STORM DOOR
B-6359-LH-W	34X76 HT L.H.W/WH.STORM
B-6359-LHE	34X76 LH ECON HT DR W/STORM
B-6359-LHWE	34X76L.H.HT W/10X10 WH.STORM
B-6359-RH	34X76 H.T.R.H.W/STORM DOOR.
B-6359-RH-W	34X76 HT R.H.W/WH.STORM
B-6359-RHE	34X76 RH ECON HT DR W/STORM
B-6359-RHWE	34X76R.H.HT W/10X10 WH.STORM
B-6361-LH	34X78 HO.TYPE L.H.W/STORM DOOR
B-6361-LH-W	34X78 HT L.H.W/WH.STORM
B-6361-LHE	34X78 H.T.L.H. W/STORM DR.
B-6361-RH	34X78 HO.TYPE R.H.W/STORM DOOR
B-6361-RH-W	34X78 HT R.H.W/WH.STORM
B-6362-LH	34X80 HO.TYPE L.H.W/STORM DOOR
B-6362-LH-W	34X80 HT L.H.W/WH.STORM
B-6362-LHE	34X80 ECON HTLH W/STORM DR.
B-6362-RH	34X80 HT R.H.W/STORM DOOR
B-6362-RH-W	34X80 HT R.H.W/WH.STORM
B-6362-RHE	34X80 ECON HT RH W/STORM DR
B-6379-LH	32 X 80 H.T.L.H.W/STORM DOOR
B-6379-RH	32 X 80 H.T.R.H.W/STORM DOOR

Specify LH and RH when ordering.

House-Type Door comes with New Door Lock and Hardware Kit

## Door with Cottage Window

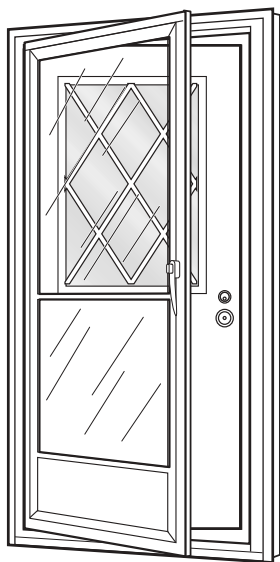

B-6340-LHCW	32X72 HT L.H. W/COT.&WH. STORM
B-6340-RHCW	32X72HT R.H.W/COT.&WH.STORM
B-6340-RHSCW	32X72HT RH STL.W/COT.&WH.STORM
B-6354-LHCW	32X76 H.T.HL W/COT.&WH.STORM
B-6354-RHCW	32X76 H.T.RH W/COT.&WH.STORM
B-6359-LHCW	34X76 HT L.H.W/COT.&WH.STORM
B-6359-RHCW	34X76 HT R.H.W/COT.& WH.STORM
B-6362-LHCW	34X80 HT L.H.W/COT.&WH.STORM
B-6362-RHCW	34X80 HT R.H.W/COT.&WH. STORM

Specify LH and RH and window type when ordering.

How to Measure Doors:

Measure from door jam to door jam for width.

Measure from floor to stud for height.

All doors may not be stocked at all locations.  
Call for availability.

# Doors - House Type

## Blank Steel Door

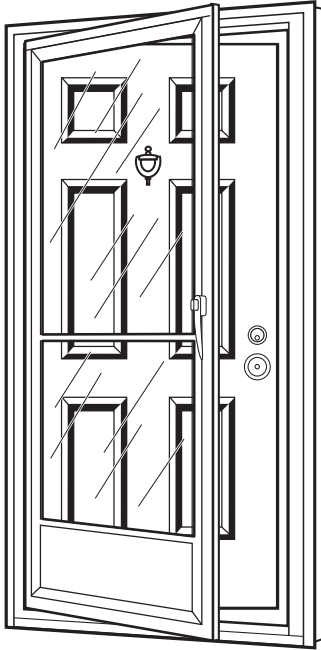

Full view storm door available.

<b>B-6332-LHSW</b>	38X80 HT L.H.STEEL W/WH.STORM
<b>B-6332-RHSW</b>	38X80 HT R.H.STEEL W/WH.STORM
<b>B-6340-LHSW</b>	32X72 HT L.H.STEEL W/WH.STORM
<b>B-6340-RHSW</b>	32X72HT R.H.STEEL W/WH.STORM
<b>B-6354-LHSW</b>	32X76 HT L.H. STEEL W/WH.STORM
<b>B-6354-RHSW</b>	32X76 HT R.H.STEEL W/WH.STORM
<b>B-6359-LHSW</b>	34X76 HT L.H.STEEL W/WH.STORM
<b>B-6359-RHSW</b>	34X76 HT R.H.STEEL W/WH.STORM
<b>B-6361-LHSW</b>	34X78 HT L.H.STEEL W/WH.STORM
<b>B-6361-RHSW</b>	34X78 HT R.H.STEEL W/WH.STORM
<b>B-6362-LHSB</b>	34X80 H.T.L.H.STEEL BRZ.DR.
<b>B-6362-LHSW</b>	34X80 HT L.H.STEEL W/WH. STORM
<b>B-6362-RHSW</b>	34X80 HT R.H.STEEL W/WH.STORM
<b>B-6368-LHSB</b>	38X82 L.H.WH. STL.DR.W/KNOCKER
<b>B-6368-RHSB</b>	38X82 R.H.WH. STL.DR.W/KNOCKER

### Residential Blank

<b>B-6368-LHSW</b>	38X82 HT LH RES.STL.W/WH.STORM
<b>B-6368-RHSW</b>	38X82 HT RH RES.STL.W/WH.STORM

Above doors come with knocker and viewer, Brass door lock and Brass Dead Bolt Lock.

## Cottage Window Steel Door

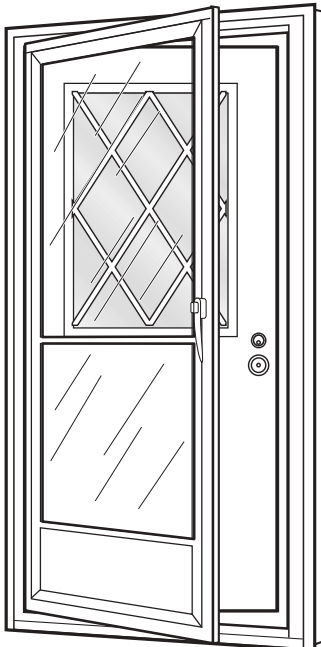

<b>B-6340-LHSCW</b>	32X72HT LH.STL.W/COT.&WH.STORM
<b>B-6340-RHSCW</b>	32X72HT RH STL.W/COT.&WH.STORM
<b>B-6354-LHSCW</b>	32X76HT LH STL.W/COT.&WH.STORM
<b>B-6354-RHSCW</b>	32X76HT RH STL.W/COT.&WH.STORM
<b>B-6359-LHSCW</b>	34X76HT LH STL.W/COT.&WH.STORM
<b>B-6359-RHSCW</b>	34X76HT RH STL.W/COT.&WH.STORM
<b>B-6362-LHSCW</b>	34X80 LH STL.W/COT.&WH.STORM
<b>B-6362-RHSCW</b>	34X80HT RH STL.W/COT.&WH.STORM

### Residential Cottage

<b>B-6368-LHSCW</b>	38X82HT LH RES.STL.W/C.&WH.STR
<b>B-6368-RHSCW</b>	38X82HT RH RES.STL.W/C.&WH.STM

Specify LH and RH and window type when ordering.

#### How to Measure Doors:

- Measure from door jam to door jam for width.
- Measure from floor to stud for height.

All doors may not be stocked at all locations.  
Call for availability. Fullview storm door available.

# Doors - Storm

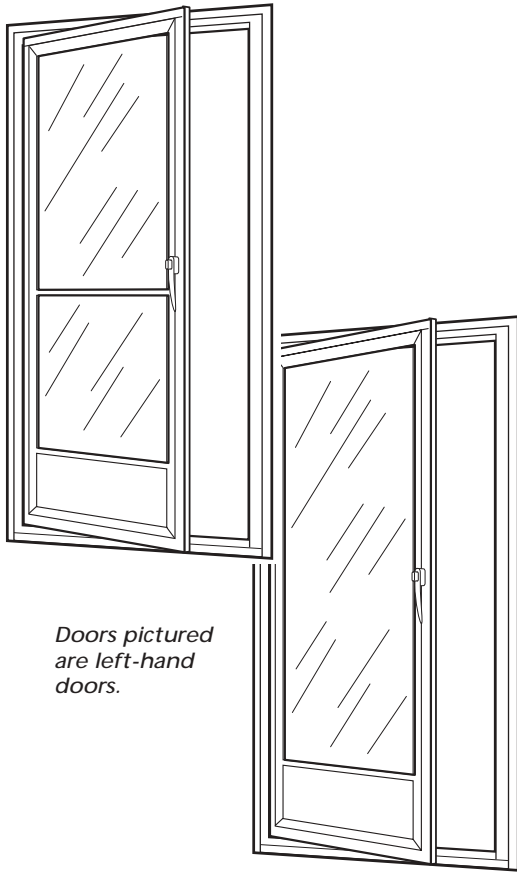

*Doors pictured are left-hand doors.*

## Residential Type

- \*B-6389-LHW
- \*B-6389-LHWFV
- B-6389-RH-W
- B-6390-LH
- B-6390-LH-W
- B-6390-RH
- B-6390-RH-W
- B-6391-LH
- B-6391-LH-W
- B-6391-RH
- B-6391-RH-W
- B-6392-LH
- B-6392-LH-W
- B-6392-RH
- B-6392-RH-W
- B-6393-LH
- B-6393-LH-W
- B-6393-RH
- B-6393-RH-W
- B-6394-LH
- B-6394-LH-W
- B-6394-RH
- B-6394-RH-W
- B-6395-LH
- B-6395-LH-W
- B-6395-RH
- B-6395-RH-W
- B-6396-LH
- B-6396-LH-W
- B-6396-RH
- B-6396-RH-W
- B-6397-LH
- B-6397-LH-W
- B-6397-RH
- B-6397-RH-W
- B-6398-LH
- B-6398-LH-W
- B-6398-RH
- B-6398-RH-W
- B-6399-LH
- B-6399-LH-W
- B-6399-RH
- B-6399-RH-W

- 38 X 82 L.H.WHITE STORM
- 38X82R.H.WH.STORM
- 32X72 L.H.STORM DOOR W/HDWE.
- 32X72L.H.WH.STORM
- 32X72 R.H.STORM DOOR W/HDWE.
- 32X72R.H.WH.STORM
- 32X74 L.H.STORM DOOR W/HDWE.
- 32X74 L.H.WH.STORM
- 32X74 R.H.STORM DOOR W/HDWE.
- 32X74 R.H.WH.STORM
- 32X76 L.H.STORM DOOR W/HDWE.
- 32X76L.H.WH.STORM
- 32X76 R.H.STORM DOOR W/HDWE.
- 32X76R.H.WH.STORM
- 34 X 76 L.H. STORM DOOR W/HDWE
- 34X76L.H.WH.STORM
- 34 X 76 R.H.STORM DOOR W/HDWE
- 34X76R.H.WH.STORM
- 34 X 78 L.H.STORM DOOR W/HDWE.
- 34X78L.H.WH.STORM
- 34 X 78 R.H.STORM DOOR W/HDWE.
- 34X78R.H.WH.STORM
- 34 X 80 L.H.STORM DOOR W/HDWE.
- 34X80L.H.WH.STORM
- 34 X 80 R.H.STORM DOOR W/HDWE.
- 34X80R.H.WH.STORM
- 32 X 78 L.H.STORM DOOR W/HDWE.
- 32X78L.H.WH.STORM
- 32 X 78 R.H.STORM DOOR W/HDWE.
- 32X78R.H.WH.STORM
- 32X80 L.H.STORM DOOR W/HDWE.
- 32X80L.H.WH.STORM
- 32X80 R.H.STORM DOOR W/HDWE.
- 32X80R.H.WH.STORM
- 36X80 L.H.STORM DOOR W/HDWE.
- 36X80L.H.WH.STORM
- 36X80 R.H.STORM DOOR W/HDWE.
- 36X80R.H.WH.STORM
- 38X80 L.H.STORM DOOR W/HDWE.
- 38X80L.H.WH.STORM
- 38X80 R.H.STORM DOOR W/HDWE.
- 38X80R.H.WH.STORM

**White Special Order Only**

All doors may not be stocked at all locations. Call for availability.

# Doors - Interior

## Prefinished Doors

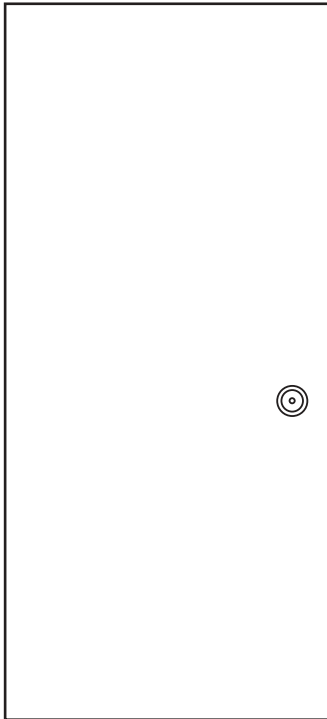

<b>B-63761</b>	30" X 80" OAK INTERIOR DOOR
<b>B-63762</b>	30" X 80" WHITE INTERIOR DOOR
<b>B-63764</b>	30"X78"X1 1/8"WHITE INTERIOR DOOR
<b>B-63771</b>	20" X 80" OAK INTERIOR DOOR
<b>B-63772</b>	20" X 80" WHITE INTERIOR DOOR
<b>B-63773</b>	26" X 80" OAK INTERIOR DOOR
<b>B-63774</b>	26" X 80" WHITE INTERIOR DOOR
<b>B-63775</b>	32" X 80" OAK INTERIOR DOOR
<b>B-63776</b>	32" X 80" WHITE INTERIOR DOOR
<b>B-63777</b>	36" X 80" OAK INTERIOR DOOR
<b>B-63778</b>	36" X 80" WHITE INTERIOR DOOR
<b>B-63781</b>	24" X 80" OAK INTERIOR DOOR
<b>B-63782</b>	24" X 80" WHITE INTERIOR DOOR
<b>B-63784</b>	24"X78"X1 1/8" WHITE INTERIOR DR.
<b>B-63791</b>	28" X 80" OAK INTERIOR DOOR
<b>B-63792</b>	28" X 80" WHITE INTERIOR DOOR
<b>B-63794</b>	28"X78"X1 1/8" WHITE INTERIOR DOOR

All doors may not be stocked at all locations.  
Call for availability.

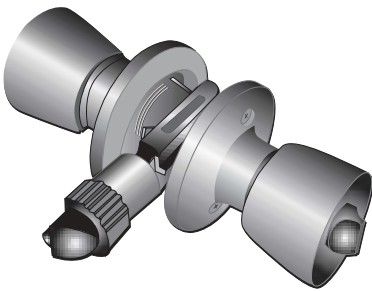

- B-2939**      PASSAGE DOOR LOCK
- B-2940**      PRIVACY DOOR LOCK

Brass plated with plastic plunger.

## Interior Door Hardware

- B-6375**  
HINGE F/INTERIOR DOOR  
Brass, non-mortise hinges are poly-bagged in pairs with 8 screws.

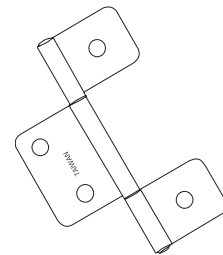

- B-6375-S**      PHILLIP BRASS HINGE SCREW  
100x Brass Hinge Screws

# Doors - Installation

## House Type

- 1) Rough opening preparation by home manufacturer.
  - A) Select studs for the door framing that are not warped or twisted.
  - B) Check rough opening for proper dimension.  
Call size of door equals rough opening size.  
Example: 34 x 80 call = 34" x 80" Rough Opening Size.
  - C) Measure rough opening for squareness.  
It should not vary by 1/4" on the diagonal dimension. (See illustration)

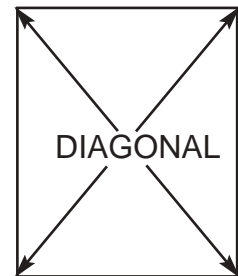

- 2.) Door installation by home manufacturer.

A) Be sure to leave all retaining straps, shipping blocks and shipping clips in place until installation is complete.  
Note: When shipping clips are removed, replace the screws.

B) Apply sealant (putty tape or pumpable caulk) to the backside of the mounting flange. (See illustration)  
Note; It is essential to have an adequate seal between the door and rough opening.

C) Apply sealant to the front edge of the rough opening floor or to the backside of the threshold on the front leg. (See illustration)

D) Set the door on the floor and center into the rough opening. Fasten the door with screws. Drive the first six screws in order according to the indicated number. (See illustration)

E) Apply the balance of the screws working from the middle to the corners.  
Note: screws should penetrate the stud at least 1 1".

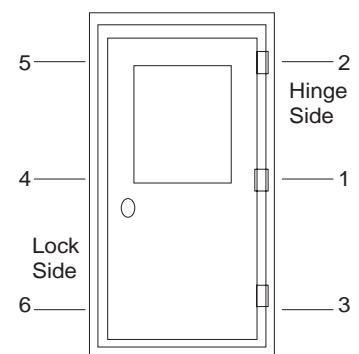
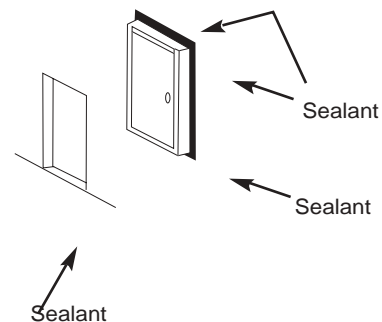

# Doors - Installation

## House Type

- F) From the inside of the house, place shims between the frame and the opening at the hinge positions on both sides of jamb. (See illustration)

Note: To hold the jamb straight, shims should only be used if there is a gap between the doorjamb and sidewall stud. Do not force shims in.

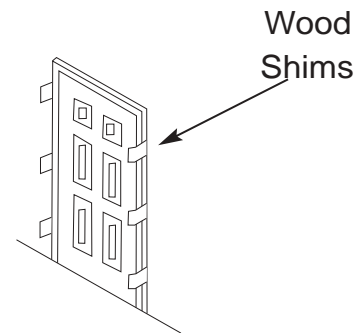

- G) Open the door. Run one long screw (provided) through the center of each hinge, penetrating the shims and the studs. (See illustration)

- H) Run long screws (not provided) through the jamb and shims on the lock side especially at strike plate.

- 1) Install all hardware on the primary door and storm door including replacing the shipping clips for transit.

- J) Caulk around the outside of the mounting flange and threshold where needed to insure a water-tight seal.

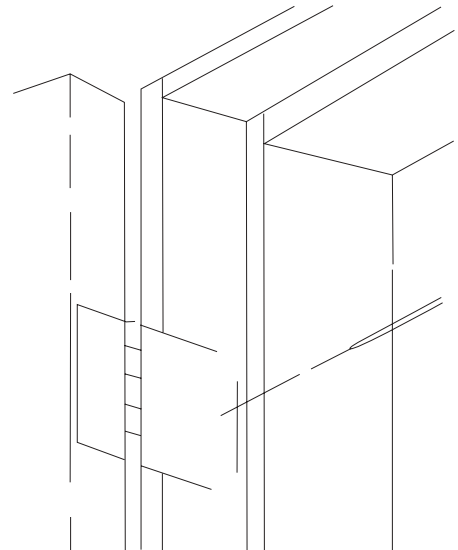

3. It is acceptable to temporarily install the door or ship the door loose in the house and install it when the house is set, providing the opening is protected from the elements. All of the above steps will need to be followed when the door is permanently installed.

# Mobile Doors-Installation

## Mobile Home

The door must be installed correctly or it may not function properly. Improper installation may void the product warranty.

Side wall rough opening must be framed to the prescribed dimensions. Door call size equals the rough opening dimensions. (See Illustration 1).

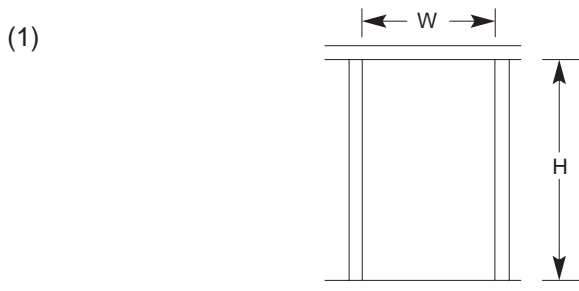

### Common Door Sizes (Wx H)

Door call sizes equal rough opening dimensions.

32" x 76"  
32" x 78"

34" x 76"  
34" x 80"

Rough openings must be within + 1/4" / -0" of prescribed dimensions.

Side wall opening must be square. This can be checked by measuring two corner points diagonally. The diagonal measurements must be within +/- 1/4" of each other. (See Illustration 2)

(2)

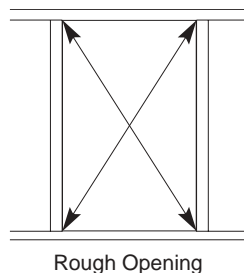

Apply a suitable nonhardening sealant to the back side of the door mounting surface around the entire perimeter (head, sill and sides), making sure to cover the mounting holes with at least 1/4" wide application of sealant. There should be no gaps or voids in the sealant application.

Note: Fasteners must be of sufficient size so that

Lane McDuff Sales Company • [www.lanemcduff.com](http://www.lanemcduff.com)

they penetrate the framing stud at least 1".

The door must be inserted and centered in the rough opening. The bottom of the door frame should be firmly seated against the floor or sill plate. Do not remove the presquaring clips prior to securing the door into the wall.

While holding the door flat against the wall, install three (3) fasteners into the predrilled holes on the hinge side of the mounting flange in line with the hinges. (See Illustration 3). The fasteners must be driven straight into the wall framing member.

(3)

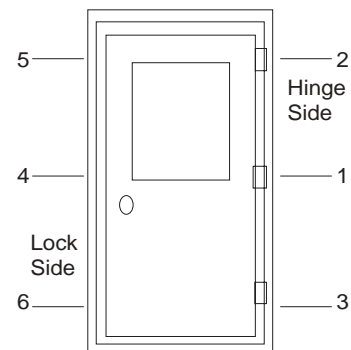

Install the three screws into the predrilled holes in the lock side of the mounting flange in line with the hinges.

Install the remaining screws in the predrilled holes in the mounting flange around the perimeter of the door. Care should be taken not to over torque or tighten down the screws too firmly.

Once the door is securely fastened into place, remove the presquaring clips, install any remaining door hardware and adjust the strike plate so that the door closes and seals properly.

# Doors - Installation

Mobile Home

## Helpful Installation Hints and Tip

(A)  
If sidewall metal is not cut out squarely at bottom of rough opening, door cannot be installed properly. Door will not operate properly as a result. Do not leave rounded sidewall metal protruding into door opening. Cut it out square with door opening.

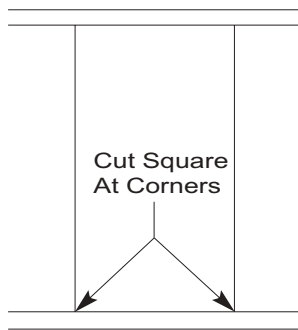

(C)  
Do not install plywood jamb liner until door has been completely installed. Door must be allowed to protrude its full depth into the rough opening.

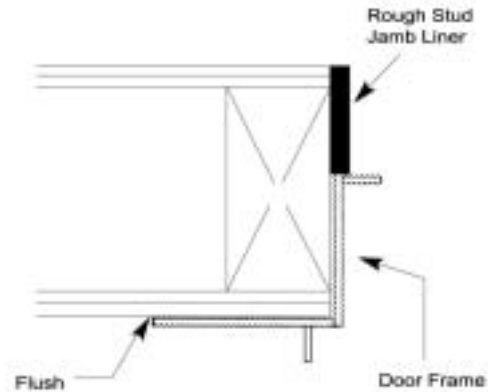

(B)  
Sidewall belt rails must be cut even with vertical stud. If not, door opening is reduced. Door outer frame will bind against protruding pieces of belt rail wood.

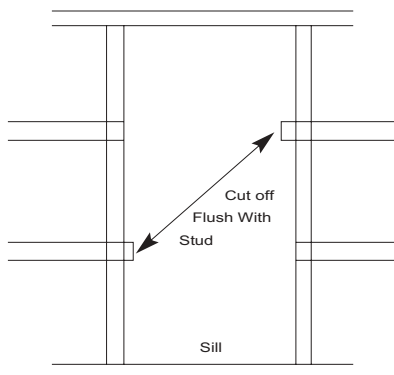

(D)  
Avoid excessive buildup of sealant under door frame mounting flange. Buildup of sealant may cause frame rotation and/or distortion which will effect the operation of the door system.

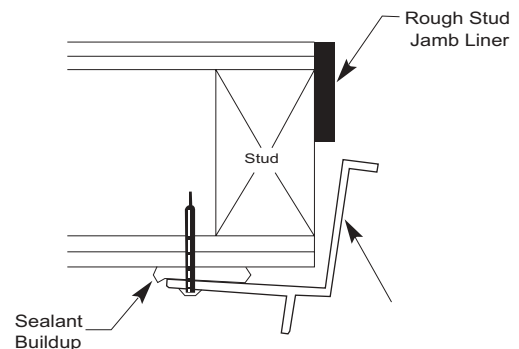

# Knobs & Locks

## Entrance Lock Only

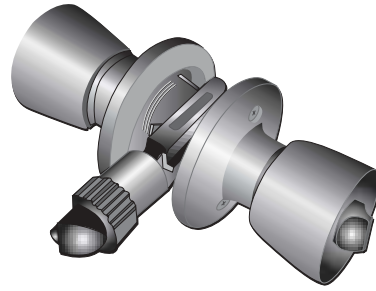

**B-2939** BRASS PASSAGE DOOR LOCK  
**B-2940** BRASS PRIVACY DOOR LOCK

## Deadbolt

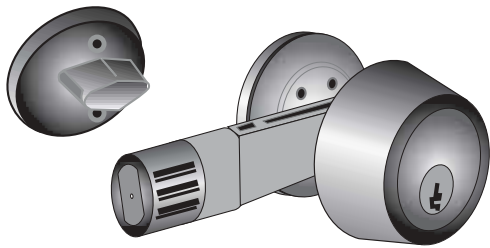

**B-2942-S** STAINLESS DEAD BOLT LOCK  
MASTER KEYED

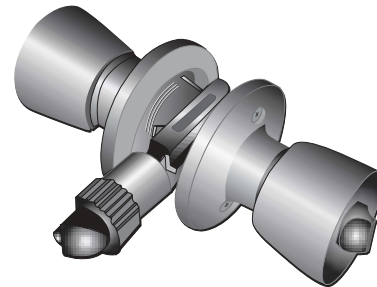

**B-2943-A** ALUMINUM KxK DOOR LOCK  
**\*B-2922** ALUMINUM 2/KEYED ALIKE  
DOOR LOCK

## One-Sided Deadbolt

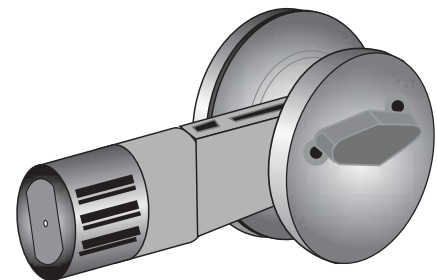

**B-2915** KEYLESS ALUMINUM  
DEAD BOLT LOCK

## Entrance Lock & Deadbolt Set

Keyed-alike entrance and deadbolt lock set. Great security, specially designed for manufactured home doors, tested residential grade. Entrance lock is master-keyed.

**B-2920-S** STAINL. ENT. LK. W/D.BLT.LK.KEYED  
**\*B-2922** ALUM. 2/ KEYED ALIKE DOOR LOCK  
**B-2924** ALUM. 4/ KEYED LK.2-EN.2-DB

# Hardware & Accessories

## Replacement Door Windows

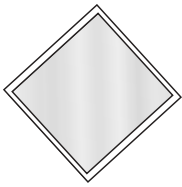

**B-6371**  
14" X 27" SLIDER  
WINDOW W/FRAME

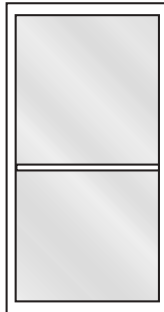

**B-63701**  
10" X 10" WINDOW  
FOR DOOR



**B-6370**  
4" X 24" GLASS  
& FRAME ONLY

**B-63705**  
9-LITE WINDOW  
FOR DOOR

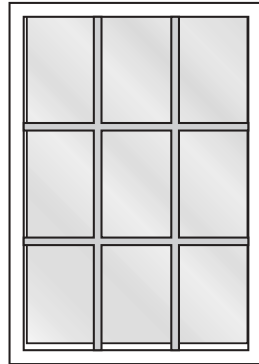

## Heavy-Duty Wind Chain

**B-2962**  
HEAVY-DUTY  
WIND CHAIN



No. 002, for all screen, storm and combination doors. Heavy tension spring, link chain. Hold-up spring keeps chain out of glass or screen area. Installs securely with heavy duty bracket, long screws.

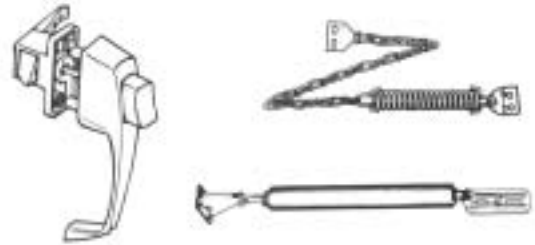

## Storm Door Kit

**B-2961-K** STORM DOOR HARDWARE KIT  
• A complete set containing all necessary hardware for installing a wood or metal combination door, 1" to 1-1/4" thick.

## Drip Cap



**B-2981** 43" ALUMINUM DRIP CAP  
**B-2981-W** 43" WHITE DRIP CAP

Install over doors and windows to channel away rain and snow. The confined caulking area insures neat appearance and positive seal.

## Hole Repair & Doorstop



**E-5806** BAGGED DOOR KNOB STOP

Solve two problems at the same time: patch over unsightly holes from door knobs, and install doorstop to prevent recurrence. Light switch colored, paintable, self adhesive and elastic. 4".

# Windows



## Bathroom Windows

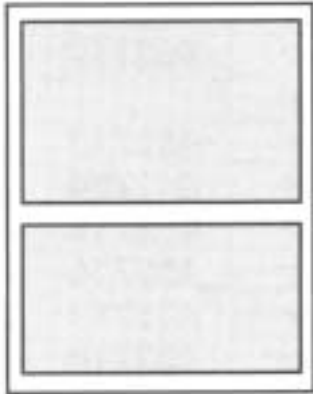

Vertical slider-type window with obscure glass - perfect for bathrooms. Mill finish.

- |        |                                |
|--------|--------------------------------|
| B-6553 | 14X 21 VERTICAL SLIDER OBSCURE |
| B-6554 | 18X 27 VERTICAL SLIDER OBSCURE |
| B-6558 | 14X 27 VERTICAL SLIDER OBSCURE |
| B-6559 | 14X 30 VERTICAL SLIDER OBSCURE |
| B-6560 | 16X 33 VERTICAL SLIDER OBSCURE |
| B-6561 | 36X8 HORIZONTAL OBSCURE WINDOW |

## Storm Windows

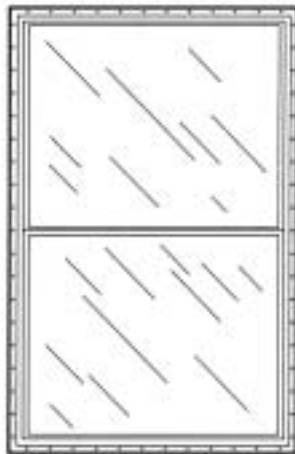

Vertical Storm

- |           |                               |
|-----------|-------------------------------|
| B-6524    | 14 X 40 VERTICAL STORM WINDOW |
| B-6525    | 24 X 27 VERTICAL STORM WINDOW |
| B-6526    | 24x53 VERTICAL STORM WINDOW   |
| B-6527    | 24 X 60 VERTICAL STORM WINDOW |
| B-6528    | 30 X 21 VERTICAL STORM WINDOW |
| B-6529    | 30 X 27 VERTICAL STORM WINDOW |
| B-6530    | 30 X 36 VERTICAL STORM WINDOW |
| B-6531    | 30 X 40 VERTICAL STORM WINDOW |
| B-6532    | 30 X 53 1/2 VERT.STORM WINDOW |
| B-6532-AC | 30 X 53 VERTICAL STORM ACTUAL |
| B-6533    | 36 X 40 VERTICAL STORM WINDOW |
| B-6534    | 46 X 27 VERTICAL STORM WINDOW |
| B-6534-A  | 40 X 27 VERTICAL STORM WINDOW |
| B-6535    | 46 X 40 VERTICAL STORM WINDOW |
| B-6536    | 46 X 53 VERTICAL STORM WINDOW |
| B-6537    | 30x30 VERTICAL STORM WINDOW   |
| B-6538    | 30 X 60 VERTICAL STORM WINDOW |
| B-6539    | 30 X 58 VERTICAL STORM ACTUAL |

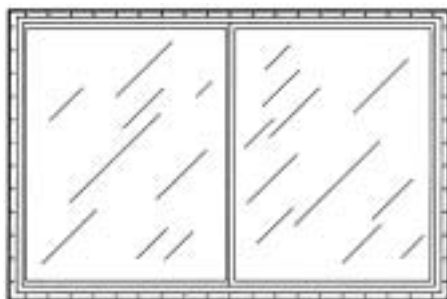

Horizontal Storm

- |        |                               |
|--------|-------------------------------|
| B-6540 | 24X14 HORIZONTAL STORM WINDOW |
| B-6541 | 30X27 HORIZONTAL STORM WINDOW |
| B-6542 | 30X40 HORIZONTAL STORM WINDOW |
| B-6543 | 46X27 HORIZONTAL STORM WINDOW |
| B-6544 | 46X40 HORIZONTAL STORM WINDOW |
| B-6545 | 62X27 HORIZONTAL STORM WINDOW |
| B-6546 | 62X40 HORIZONTAL STORM WINDOW |
| B-6547 | 36X27 HORIZONTAL STORM WINDOW |
| B-6548 | 36X40 HORIZONTAL STORM WINDOW |

## Sliding Windows

B-6500	24 X 27 VERTICAL SLIDER WINDOW
B-6500-W	24X27 WHITE VERT.SLIDER WINDOW
B-6501	24 X 53 VERTICAL SLIDER WINDOW
B-6501-W	24X53 WHITE VERT.SLIDER WINDOW
B-6502	24 X 60 VERTICAL SLIDER WINDOW
B-6502-W	24X60 WHITE VERT.SLIDER WINDOW
B-6503	30 X 21 VERTICAL SLIDER WINDOW
B-6503-W	30X21 WHITE VERT.SLIDER WINDOW
B-6504	30 X 27 VERTICAL SLIDER WINDOW
B-6504-3	30 X 30 VERTICAL SLIDER WINDOW
B-6504-3-W	30X30 WHITE VERT.SLIDER WINDOW
B-6504-W	30X27 WHITE VERT.SLIDER WINDOW
B-6505	30 X 36 VERTICAL SLIDER WINDOW
B-6505-W	30X36 WHITE VERT.SLIDER WINDOW
B-6506	30 X 40 VERTICAL SLIDER WINDOW
B-6506-W	30X40 WHITE VERT.SLIDER WINDOW
B-6507	30 X 53 1/2 VERT.SLIDER WINDOW
B-6507-AC	30 X 53 VERT.SLIDER ACT BRONZE
B-6507-AC-W	30X53 WHITE VERT.SLIDER WINDOW
B-6507-W	30X53 1/2 WH.VERT.SLIDER WIND.
B-6508	36 X 40 VERTICAL SLIDER WINDOW
B-6508-W	36X40 WHITE VERT.SLIDER WINDOW
B-6509	40 X 27 VERTICAL SLIDER WINDOW
B-6509-W	40X27 WHITE VERT.SLIDER WINDOW
B-6510	46 X 27 VERTICAL SLIDER WINDOW
B-6510-W	46X27 WHITE VERT.SLIDER WINDOW
B-6511	46 X 40 VERTICAL SLIDER WINDOW
B-6511-W	46X40 WHITE VERT.SLIDER WINDOW
B-6512	46 X 53 VERTICAL SLIDER WINDOW
B-6512-W	46X53 VERT.SLIDER WINDOW
B-6513	30 X 60 VERTICAL SLIDER WINDOW
B-6513-AC	30 X 58 VERT. SLIDER ACTUAL
B-6513-ACW	30X58 WHITE VERT.SLIDER ACTUAL
B-6513-W	30X60 WHITE VERT.SLIDER WINDOW
B-6514-1	15 X 30 VERTICAL SLIDER WINDOW
B-6514-1-W	15X30 WHITE VERT.SLIDER WINDOW
B-6514-2	24 X 18 VERTICAL SLIDER WINDOW
B-6514-2-W	24X18 WHITE VERT.SLIDER WINDOW
B-6514-3	14 X 40 VERTICAL SLIDER WINDOW
B-6514-3-W	14X40 WHITE VERT.SLIDER WINDOW
B-6515	24 X 14 HORIZONTAL SLIDER

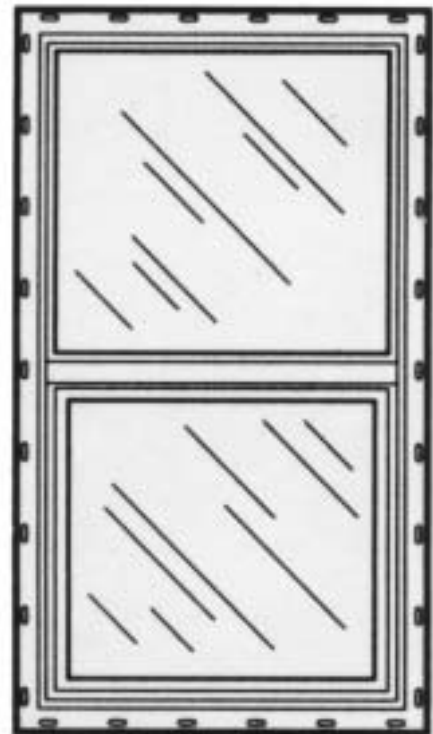
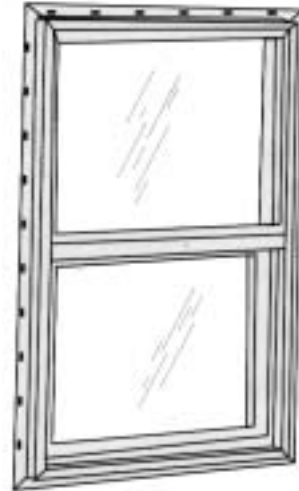

# Windows



## Sliding Windows

B-6515-W	24 X 14WHITE HORIZONTAL SLIDER
B-6516	30 X 27 HORIZONTAL SLIDER
B-6516-1	30 X 15 HORIZONTAL SLIDER
B-6516-1W	30 X 15WHITE HORIZONTAL SLIDER
B-6516-W	30 X 27WHITE HORIZONTAL SLIDER
B-6517	30 X 40 HORIZONTAL SLIDER
B-6517-W	30 X 40WHITE HORIZONTAL SLIDER
B-6518	46 X 27 HORIZONTAL SLIDER
B-6518-W	46 X 27WHITE HORIZONTAL SLIDER
B-6519	46 X 40 HORIZONTAL SLIDER
B-6519-W	46 X 40WHITE HORIZONTAL SLIDER
B-6520	62 X 27 HORIZONTAL SLIDER
B-6520-W	62 X 27WHITE HORIZONTAL SLIDER
B-6521	62 X 40 HORIZONTAL SLIDER
B-6521-W	62 X 40WHITE HORIZONTAL SLIDER
B-6522	36 X 27 HORIZONTAL SLIDER
B-6522-W	36 X 27WHITE HORIZONTAL SLIDER
B-6523	36 X 40 HORIZONTAL SLIDER
B-6523-W	36 X 40WHITE HORIZONTAL SLIDER

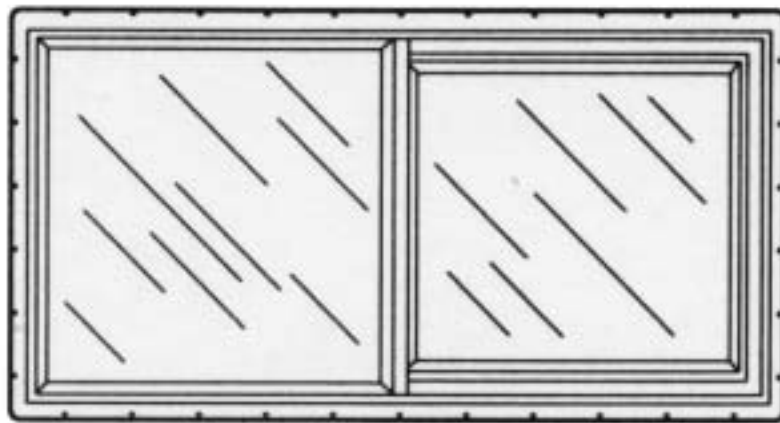

## Vinyl Windows

Strong, durable, no maintenance all-vinyl chambered frame never needs painting.

- Heat fusion welding bonds frame and sash corners, preventing water and air infiltration at the joints.
- The narrow frame and sash profiles allow a large glass area for maximum exterior view.
- Interlocking meeting rails provide a superior sealing system that keeps out wind & water.
- Universal design for all wall siding applications. (Lap siding requires J-rail #462762.)
- Sash tilts inward; can be removed for cleaning from inside.
- Full 3/4 insulating glass for optimum thermal performance. Optional Low-E coated glazing is available.
- Easy to use mull system allows windows to be joined with each other to create interesting combinations.



B-6900	14 X 27 WHITE VINYL WINDOW
B-6901	14 X 40 WHITE VINYL WINDOW
B-6902	14 X 53 WHITE VINYL WINDOW
B-6903	24 X 40 WHITE VINYL WINDOW
B-6904	24 X 53 WHITE VINYL WINDOW
B-6905	24 X 58 WHITE VINYL WINDOW
B-6906	24 X 68 WHITE VINYL WINDOW
B-6907	30 X 27 WHITE VINYL WINDOW
B-6908	30 X 36 WHITE VINYL WINDOW
B-6909	30 X 40 WHITE VINYL WINDOW
B-6910	30 X 53 WHITE VINYL WINDOW
B-6911	30 X 63 WHITE VINYL WINDOW
B-6912	30 X 68 WHITE VINYL WINDOW
B-6913	36 X 36 WHITE VINYL WINDOW
B-6914	36 X 53 WHITE VINYL WINDOW
B-6915	36 X 58 WHITE VINYL WINDOW
B-6916	36 X 68 WHITE VINYL WINDOW
B-6917	46 X 40 WHITE VINYL WINDOW
B-6918	46 X 53 WHITE VINYL WINDOW

# Windows - Installation

The window must be installed correctly or it may not function properly. Improper installation may void the product warranty.

**NOTE: For installation and operation, Philips recommends a minimum of a 4-inch nominal wall thickness.**

Figure 1

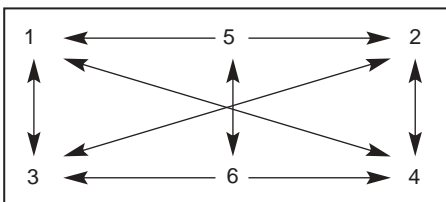

1. Check the squareness of the rough opening. The difference between 1 to 4 and 2 to 3 should not exceed 1/4". Fig. 1

Width Measurement (1 to 2) and (3 to 4).  
Add 1/4" to window buck dimension.

Height Measurement (1 to 3) and (2 to 4).  
Add 3/16" to window buck height dimension.

For windows over 27" in width, check the middle of the rough opening height measurements. This measurement should equal +3/16" over window buck height dimension.

**NOTE: The opening must be clear and free of obstructions that would hinder the proper installation of the window.**

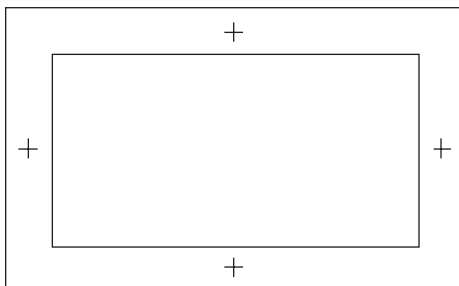

Figure 2

2. Apply sealant tape to the back of all sides of the mounting flange centering the tape over the holes in the mounting flange, making sure there are no gaps of voids, so as to prevent the window from leaking. Optional use of cartridge or gun type caulk is permitted. Use at least a 1/4" bead centered over the holes in the mounting flange.
3. Place window in the opening, sill resting on the bottom of the opening and centered.
4. While holding the window flat against the exterior wall, start the first fastener as close to the center as possible on one of the side frame mounting flanges. The second fastener should go on the opposite side. The third fastener should be as close to the center as possible on the bottom frame mounting flange and the fourth fastener should be centered on the top. (Note: If scaffolding interferes with the top of the window, it is acceptable to install this later when it is more accessible.)
5. After the primary fasteners have been installed, check the window to be certain it is centered in the opening. Install the rest of the fasteners, starting in the center of each member, progressing out towards the corners, through the holes provided in the window.

**NOTE: When installing Philips prime windows, we recommend using fasteners which allow for a minimum of 1" stud penetration at 4" o.c. for over siding applications and 8" o.c. for under siding applications.**

6. Remove shipping clips and check window for proper operation.
7. On lap siding windows, install siding over flange, extending the siding into the jamb pocket, according to siding manufacturer's recommendation.

# Windows - Installation

## Egress Window Installation: For installation

\* Follow steps 1 through 7.

### NOTE:

No mounting system shall be used that will affect the operation of the egress provisions of the window, nor shall appurtenance mounting clips or latches be changed or additional ones installed.

The use of any trim and storm system not approved for the unit nullifies the certification and any alterations of any approved trim and storm nullifies the certification.

The installed egress window with the trim and storm system in the mobile home must comply with Sections 3280.404(b) and 3280.404(c) of the Federal Mobile Home Construction and Safety Standard.

Do not place any furniture or other objects in front of the egress unit that will prevent the occupant from reaching it for its intended use. Coverings which might impede access may render this emergency exit unusable during a fire or similar disaster.

Window must demonstrate egress capability before installation can be considered complete. When home is placed (leveled) on its site, the window must be rechecked for satisfactory egress function.

The operating instructions and certification label are a permanent part of the unit and must not be removed.

Should any of these instructions be disregarded, the certification as an egress unit is immediately nullified and the unit will no longer be considered an egress window.

## Installation of Trim & Storm System.

We offer 2 basic trim and storm concepts or self-storing storm options.

1. **Trim and storm for horizontal or vertical sliding window installation.** Hold frame, with storm window installed, up to opening. Square up trim, center and attach to wall - sill first (2 to 6 fasteners). See Figure 3. The storm sash must be in the trim while being installed.
2. **Self-storing storm for horizontal or vertical sliding window installation.** Place self-storing storm in the opening. Center the window and attach to wall - sill first (2 to 4 fasteners), then head (2 to 4 fasteners), the jambs (2 to 4 fasteners). See Figure 3. Remove shipping clips.

Figure 3

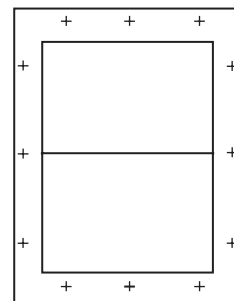
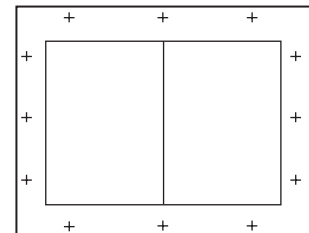

# Windows - Accessories

## Slider Window & Door Lock \* Special Order

Fits all sliding metal door and window frames, extruded aluminum mill finish thumb screw locking. Allows for various vent openings.



**\*B-6369**  
WINDOW SASH  
LOCKS

## Screen Frame



**B-6570-M**  
16' MILL  
SCREEN  
FRAME

**B-6570-W**  
16' WHITE  
SCREEN  
FRAME

## Screen Spline



**B-6571**  
WINDOW  
SCREEN  
SPLINE

## Corner Inserts

**B-6572**  
GREY SCREEN CORNER

**B-6573**  
WHITE SCREEN CORNER

Plastic screen  
frame corner  
insert. 25/Ctn.

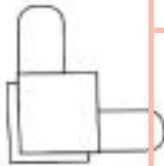

## Screen Springs



Holds window screen in window

**B-6574**  
WINDOW SCREEN  
SPRING CLIP

## Screen Wire



**B-6576**  
32"X100'  
SCREEN  
MATERIAL

**B-6576-36**  
36" X 100'  
SCREEN  
MATERIAL

## Window Bead



**B-6577**  
12' WHITE WINDOW  
VINYL BEAD

# Transport



**B-6490** 2" X 60 YD.  
BLACK BELLY TAPE

Specifically made for patching and splicing bottom board paper used in mobile homes. Certified to meet the HUD specification of the Office of Mobile Home Standards.



**B-6080** 16X100 BLACK PLASTIC SHEETING 6MIL  
**B-6081** 14X300' WHITE PLASTIC SHEETING 4 MIL

**NOTE:** This material is used to protect double-wide manufactured homes while in transit.

## Lag Bolts



**E-5714** 3/8" X 6" LAG BOLTS  
**E-5715** 3/8" X 5" LAG BOLTS  
**E-5716** 3/8" X 1-1/2" WASHERS



**B-6085** 8' X 600' BELLY BOARD PAPER  
**B-6086** 8' X 100' BELLY BOARD PAPER

## Mobile Home Piers

<b>B-6060-32</b>	32" PIER W/HEAD
<b>B-6060-34</b>	34" PIER W/HEAD
<b>B-6061</b>	8" PIER W/HEAD
<b>B-6062</b>	10" PIER W/HEAD
<b>B-6063</b>	12" PIER W/HEAD
<b>B-6064</b>	14" PIER W/HEAD
<b>B-6065</b>	16" PIER W/HEAD
<b>B-6066</b>	18" PIER W/HEAD
<b>B-6067</b>	20" PIER W/HEAD
<b>B-6068</b>	22" PIER W/HEAD
<b>B-6069</b>	24" PIER W/HEAD
<b>B-6070</b>	26" PIER W/HEAD
<b>B-6071</b>	28" PIER W/HEAD
<b>B-6072</b>	30" PIER W/HEAD
<b>B-6073</b>	36" PIER W/HEAD
<b>B-6074</b>	PIER HEADS
<b>B-6074-F</b>	PIER HEAD W/4" X 4" FLAT TOP



6,000 LB. Pier  
Stackable for easy storage, shipping and handling.

Adjustable heights for precise installation. Only 16 piers replace the 64 concrete blocks normally required to support a 70' x 14' mobile home. Ideal for quick, secure setups in dealer lots as well as the home site.

**ALL SPECIAL ORDER**

# Set-Up



## ABS Pier Pads

**Part No. 1055-14**  
16" X 16" ABS PLASTIC PAD

Economical ABS pads replace heavy, hard-to-handle concrete pads and wood pads that deteriorate, crack and split. Tested and certified in many slates. Approx. weight is 3 lbs. per pad, making life easier for the installer, easier to haul on trucks, lowers Workmen's Compensation claims and can be reused with moving homes. Lifetime guarantee.



**B-6092** 10" x 50' GALV. ROOF FLASHING

## Plywood Pad



**B-6075-34** 16"X16" X 3/4"PLYWOOD PAD

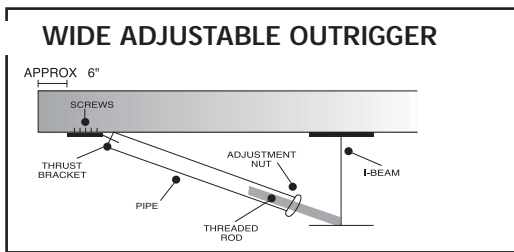

## Wide Adjustable Outrigger

**Part No.**  
**WAO-12** WIDE ADJUSTABLE OUTRIGGER  
**WAO-14** WIDE ADJUSTABLE OUTRIGGER  
**WAO-16** WIDE ADJUSTABLE OUTRIGGER  
**B-6135** LATHEWOOD (50/ BUNDLE)

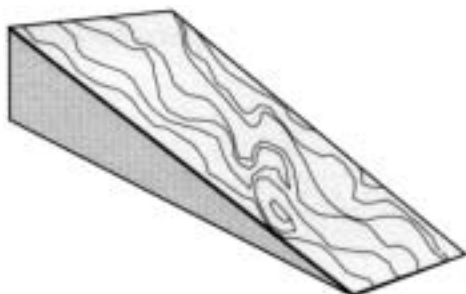

## Block Wedges

**B-6128** HARDWOOD WEDGES (100/BAG)  
**B-6128-4** 4" WIDE HARDWOOD WEDGE  
**B-6128-P** 4" X 8" 1-1/4" PINE WEDGE (100/BAG)  
**B-6128-PS** 2" X 4" X 12" PINE WEDGE (50/BAG)  
**B-6128-W** 2" X 4" X 8" WOLMANIZED WEDGES  
**B-6129** 1" X 8" X 16" WOODEN BLOCKS (20/BDL)  
**B-6129-W** 1" X 8" X 16" WOLMANIZED BLOCK (20/BDL)  
**B-6130** 2"X8"X16" WOODEN BLOCKS (10/BDL)  
**B-6130-W** 2" X 8" X 16" WOLMANIZED BLOCK(10/BDL)  
**B-6131** 2" X 6" X 16" WOODEN BLOCKS (10/BDL)

# Anchor

## Strap Buckle

**Part No.**  
**ST1-B**

STRAP  
BUCKLE

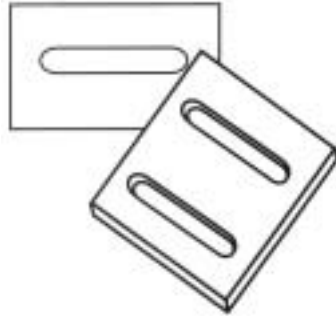

Steel strap buckle for use in fastening strap around frame of mobile home.



## Anchor Strap **Part No.**

**GALST37** 37' STRAPPING  
**GALST600** 600' STRAPPING

1-1/4" wide galvanized strapping exceeds 4,724-lbs breaking strength. (100 lb. roll Approx. 650')

## Buckle with Strap

**Part No.** 8' STRAP W/BUCKLE  
**ST1-8**

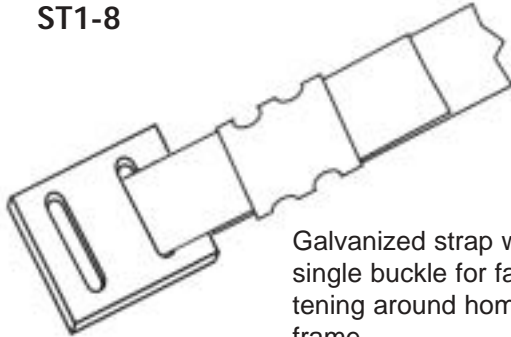

Galvanized strap with single buckle for fastening around home frame.

## Strap Extender

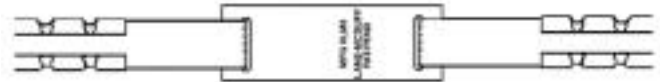

**B-6027** 6' STRAP W/ EXTENDER

PATTENED STARP USED TO LENGTHEN A STRAP

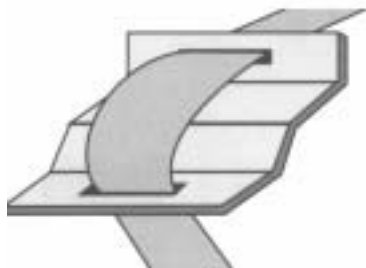

## Roof Bracket

**B-6028** GALVANIZED ROOF BRACKET

Use for cable or strap passing over the mobile home. Holds straps or cable away from roof and sides.

## Frame Tie with Strap

Frame clamp with strap for fastening around bottom flange of home frame. Frame clamp without strap also available.

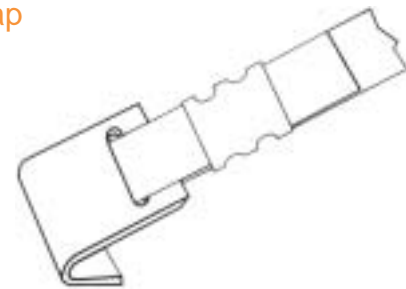

**FT1-6** 6' FRAME TIE W/STRAP  
**FT1-8** 8' FRAME TIE W/STRAP  
**FT1-12** 12' FRAME TIE W/STRAP  
**FT1-14** 14' FRAME TIE W/STRAP  
**FT1-18** 18' FRAME TIE W/STRAP

# Anchor

## Patio Slab Anchors

Patio slab hooked rod attachment with fastening and tensioning head installed when pouring concrete slab.

**Part No.**  
**CAWP**

HOOKED SLAB ANCHOR

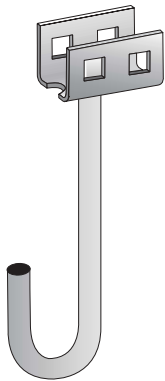

## SUPER DUTY TRIM ADHESIVE

A fast drying, super strength spray adhesive for bonding carpets, jute pads, insulation, and other applications where a high strength adhesive is required. Adjustable spray valve allows the spray pattern to be adjusted to fit the application.

**B-2383** 15 3/4 OZ. HEAVY DUTY ADHESIVE

Cap Can pot on Top of Regular 30" Anchor

**Part No.**  
**CAP1**



## Anchor Stabilizing Device

Prevents anchors from becoming loose by cutting through the soil when heavy winds occur. Required in most anchor installations.

**Part No.** **MSP2**

ANCHOR STABILIZERS

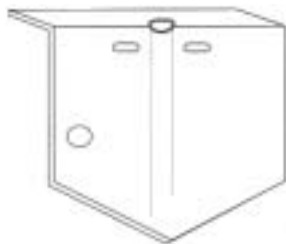

## Double Disk Anchors

30" double 4" disk earth anchor with double fastening and tensioning head for use with straps. Designed to be augered into extremely hard soil where 6" disk anchor will not suffice. 200/Skid; 8/Bundle.

**Part No.** **3044BP**

3/4" ROD-4" DBL.DISK ANCHOR  
(Recommended for Soil Classes 2 & 3)

# Anchor

## Anchor Bolt & Nut

Knurled bolt increases friction between strap and bolt shaft for greater strength than smooth bolts. Slotted for use with strap. Not included with anchor.

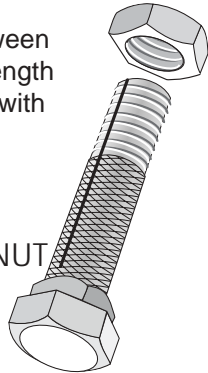

### Part No.

**SBW/N** STRAP BOLT & NUT

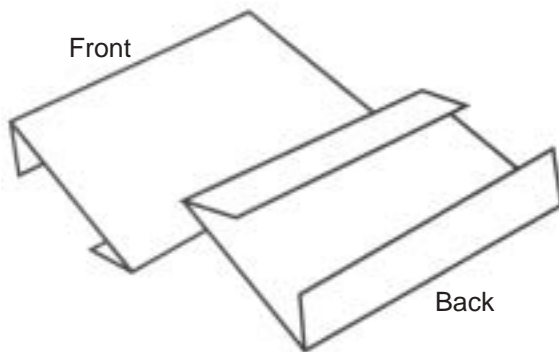

## Strap Seal

Secures or ties strapping together with buckles or frame crimping tool.

### Part No.

**CRIMPSEAL** STRAP SEAL CLAMP



- E-5003** 12 TON STANDARD AXLE JACK
- E-5004** 12 TON LOW-PROFILE AXLE JACK
- E-5005** 20 TON STD. AXLE JACK
- E-5006** 20 TON LOW PROFILE AXLE JACK

- E-5008** 12 TON HYDRAULIC REPAIR KIT
- E-5009** 20 TON HYDRAULIC REPAIR KIT
- E-5010** OIL FILL PLUG FOR JACKS

**ALL SPECIAL ORDER**

## DOUBLE HEAD PATIO ANCHOR

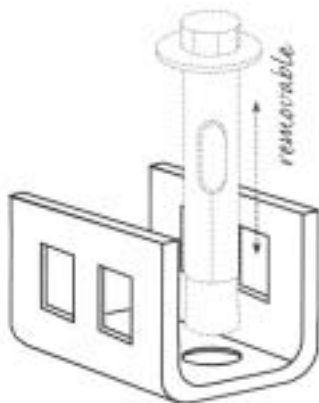

### Anchor Head With Lag Bolt

Double tensioning device for use on dry concrete or existing concrete slabs. 48/Ct.

### Part No.

**CADP**  
HEAD ONLY FOR PATIO ANCHOR



### Part No.

**N/CADP** RED HEAD  
STUDS ONLY 5/8 X 3-1/2

# Steps

## Enhance Your Home With Fiberglass Steps from Lane-McDuff

Lane-McDuff is excited to bring you the highest quality fiberglass step on the market. We know that as a homeowner you not only want an attractive product, but also a durable one. That is why our steps are made of an impact resistant fiberglass shell. You will not have to worry about wear and tear because, the durable design of our fiberglass prevents unwanted erosion and decay associated with other building materials. So if you want to make a smart, yet beautiful addition to your home go with Lane-McDuff fiberglass steps. You can reach us at any of our 11 branch locations or toll free at 1-800-792-1030.

Lane-McDuff Steps Feature:

- Improved safety with a .35 grit nonskid surface on all steps
- Weather resistant sub plywood frame
- Manufacturer's 5-year Limited Warranty
- Not effected by salt in winter
- Convenient Lifting Handles

Extensive testing proves this is the strongest and most durable step available anywhere today. The factory quality control method assures the same high standard of workmanship step after step after step. Exclusive marble-like finish is unequaled anywhere in looks and style.

<b>B-9424</b>	24"Hx34"x20"PLATFORM 3-STEP FIBERGLASS
<b>B-9424-CR</b>	20" PLATFORM 3-STEP ALUM. CODE RAIL
<b>B-9424-R</b>	20" PLATFORM 3-STEP ALUM. RAIL
<b>B-9425-BR</b>	BACK HANDRAIL 34" W/STEP
<b>B-9425-CBR</b>	CODE BACK RAIL 34" W/STEP
<b>B-9428</b>	28"Hx34"Wx20" PLATFORM 4-STEP FIBERGLASS
<b>B-9428-CR</b>	CODE RAIL FOR 24", 28" & 32" STEPS
<b>B-9428-R</b>	RAIL FOR 24", 28" & 32" STEPS
<b>B-9432</b>	32"Hx34"Wx20"P 4-STEP FIBERGLASS
<b>B-9440</b>	40"HX34"Wx20"PLATFORM 5-STEP FIBERGLASS
<b>B-9440-CR</b>	20" PLATFORM 5-STEP ALUM. CODE RAIL
<b>B-9440-R</b>	ALUM. RAIL 5-STEP 20" PLATFORM
<b>B-9444-3K</b>	3-STEPS
<b>B-9444-3KR</b>	3-STEPS RAIL
<b>B-9444-4K</b>	4-STEPS
<b>B-9444-4KR</b>	4-STEPS RAIL
<b>B-9444-5K</b>	5-STEPS
<b>B-9444-5KR</b>	5-STEPS RAIL

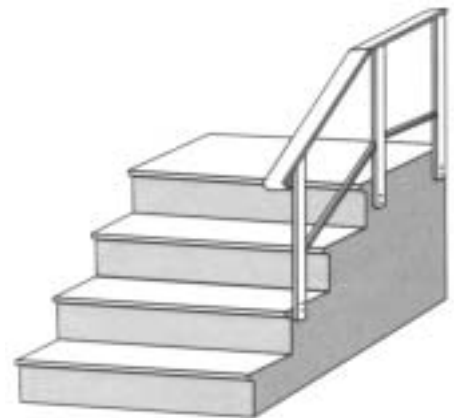

# Appliances



**L**ane-McDuff is excited to offer the Maytag line of Performa® appliances. The Performa® line of appliances offers you the value you demand from the brand you trust.™ With everything that happens in your life you need quality appliances that simplify the household chores of doing the laundry and cooking. Lane-McDuff's line of Maytag appliances are custom designed specifically to fit into your manufactured home. What's more Maytag appliances are designed with features to fit your busy lifestyle. Look to Maytag and Lane-McDuff for features that make it easier to manage your home. To find out more about how Maytag appliances can meet your needs as a manufactured home owner, contact a Lane-McDuff sales associate today!

## Electric

### Gas



## Ranges

**B-8360** MAYTAG ELC.RANGE 3-6+1-8 W/STOR

**B-8365** MAYTAG 30"GAS RANGE PILOT IGN.

## Washers & Dryers

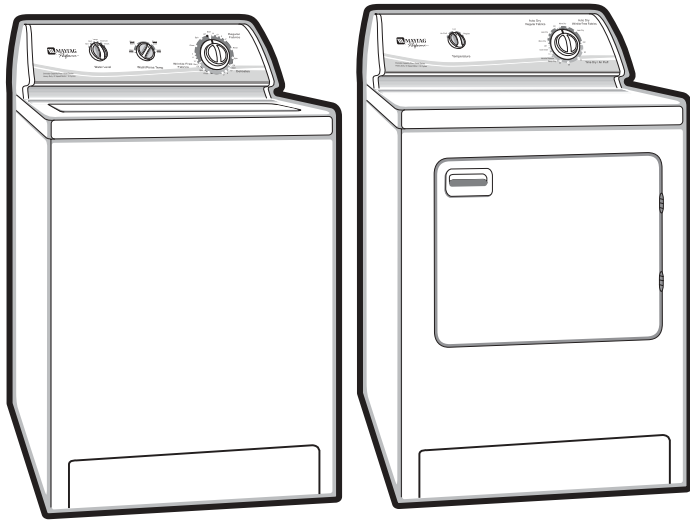

- B-8350** MAYTAG WASHER1SP-XLG-6CY-4TEMP
- B-8355** MAYTAG DRYER ELEC.4CY-3-TEMP
- B-8357** MAYTAG DRYER GAS 4CY-3TEMP

## Dishwashers

- B-8370** MAYTAG DISHWASHER 3 CYCLE

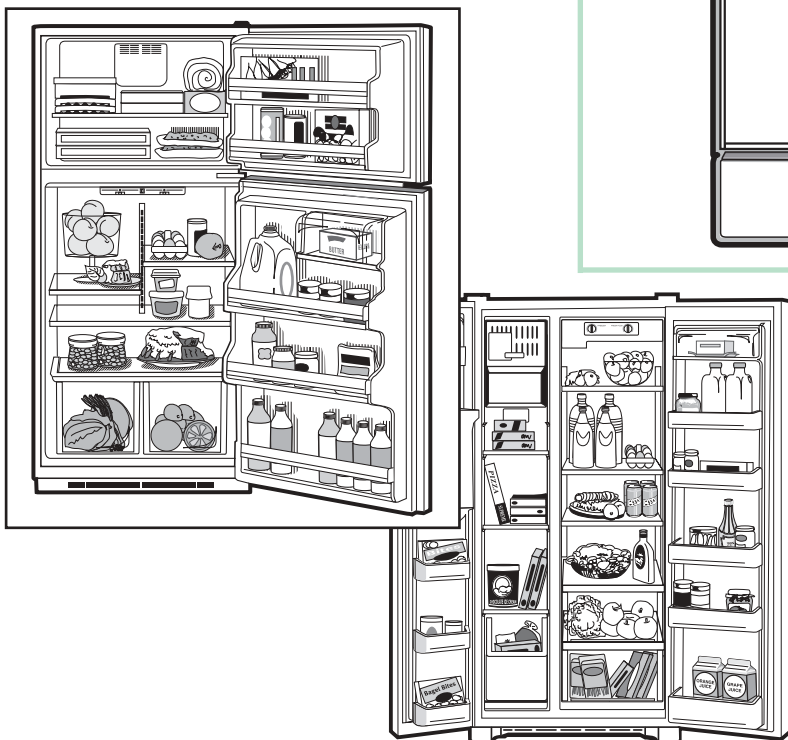
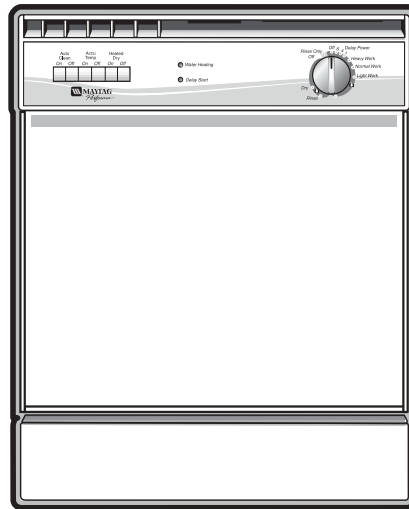

## Refrigerators

- B-8381** MAYTAG 16 CU.FT. REFRIGERATOR
- B-8382** MAYTAG 17.9 CU.FT. REFRIGERATOR
- B-8384** MAYTAG 18 CU.FT.REFRIGERATOR  
W/ICE MAKER
- B-8387** MAYTAG 21.6CU.FT.SXS  
REFRIGERATOR w/ ICE MAKER &  
WATER DISPENSER IN DOOR

# Appliances

## 4-Wire Dryer Cable

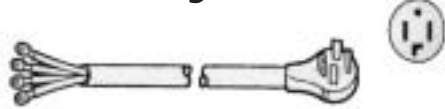

Round rubber jacketed wire, molded-on plug, Black, 4-wire for mobile homes, 4', 30 AMP

**B-2551** 4 CONDUCTOR DRYER CORD

## Dryer Receptacle

**B-2550**  
4 CONDUCTOR  
DRYER RECEPTACLE

4-wire, 30-amp, 125/250-volt dryer receptacle with "Quick-Loc" terminals.

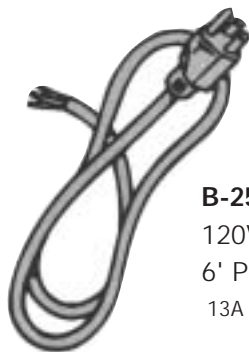
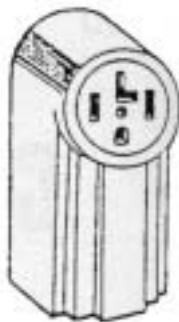

**B-2554**  
120V ELECTRIC  
6' PIGTAIL  
13A - 125V



**D-4308**  
WASHER VALVE  
1/2MPT XHOSE LONG

**D-4308-B**  
WASHER VALVE 1/2"  
MPT X HOSE LONG-  
BRASS

**D-4389**  
BRASS WASHER VALVE  
1/2MPT XHOSE LONG



**D-4385** 1/2"MPT X 3/8"MPT  
BRASS ELBOW

## Accessories

### Adjustable Continuous Waste w/Tailpiece

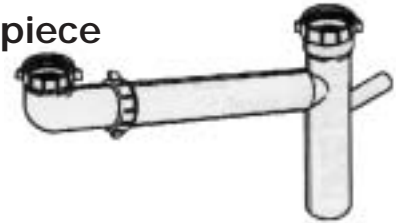

1-1/2" with dishwasher tailpiece.

**B-2128** 1 1/2 CONT. WATER W/D.W. PIECE

### Dryer Venting Kit

**B-2546** FLEX.ALUM.  
DRYER VENT KIT



4" louvered vent in white finish, aluminum tail piece. 5-foot vinyl duct, 2 clamps. Boxed. 6/Ctn.

## Range Accessories

### Range Cord

Replacement cord for all ranges having a 1-1/8" power supply entrance. Two #8 and two #6 conductors with molded cap and terminal plugs. 50 amp. 4' long.

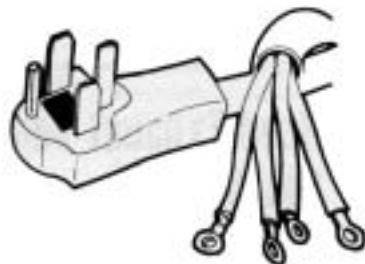

**B-2553**  
4-CONDUCTOR  
RANGE CORD

### Range Receptacle

4-wire, 50-amp, 125/250-volt range receptacle with "Quick-Loc" terminals.

**B-2552**  
4-CONDUCTOR  
RANGE  
RECEPTACLE



# Plumbing - Pipes & Fittings

## ABS Fittings and Accessories

### STEEL HANGER STRAP, COPPER COATED

- B-2996-10**      3/4" X 10' HANGER STRAP
- B-2996-100**    3/4 X 100' HANGER STRAP

Perforated steel strap is 24 gauge, zinc plated measuring 3/4". Handy for hundreds of odd jobs. Ideal for hanging, securing and anchoring piping, duct work and controls.

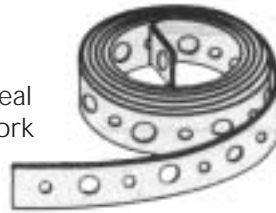

**B-2241**  
TRAY PLUG ADAPTER



### P-TRAP (w/SLIP JOINT & UNION)

- B-2290**    1-1/2" X 1-1/4"  
SLIP P-TRAP
- B-2291**    1-1/2" X 1-1/2"  
SLIP P-TRAP



### P-TRAP (w/UNION)

- B-2289**    1-1/2" X 1-  
1/2" P-TRAP W/UNION

### PIPE WRAP



### PEX TUBING

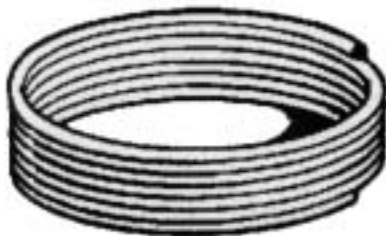

- B-220080**    1/2" X 100' PEX TUBING
- B-220081**    3/4" X 100' PEX TUBING

- B-2632**      9' HEAT TAPE W/T-STAT
- B-2633**      13' HEAT TAPE W/T-STAT
- B-2635**      18' HEAT TAPE W/T-STAT
- B-2636**      24' HEAT TAPE W/T-STAT
- B-2637**      30' HEAT TAPE W/T-STAT
- B-2638**      45' HEAT TAPE W/T-STAT
- B-2639**      60' HEAT TAPE W/T-STAT
- B-2640**      80' HEAT TAPE W/T-STAT

Stocked only at the Abilene, Texas and Albuquerque, New Mexico Lane-McDuff Branches.

# Plumbing - Fittings

## Flair-It Fittings

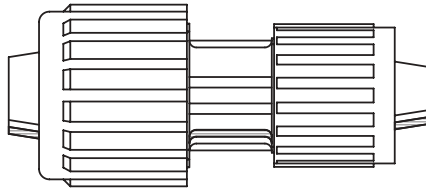

**Coupling**

- D-4601** 1/2" P x 3/8"P
- D-4602** 1/2" P x 1/2"P
- D-4603** 3/4" x 1/2"P
- D-4604** 3/4" P x 3/4"P

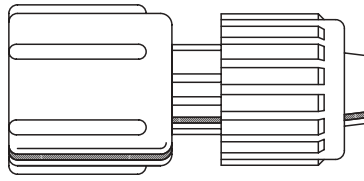

**Faucet to Flair-It Connection**

- D-4611** 1/2"P x 1/2" FPT SWIVEL BSP

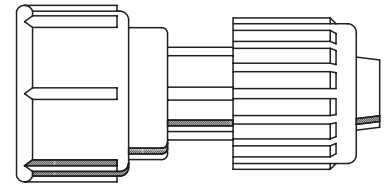

**Toilet to Flair-It Connection**

- D-4616** BALLCOCK ADAPT. 1/2"P x 3/4" BCT SWIVEL

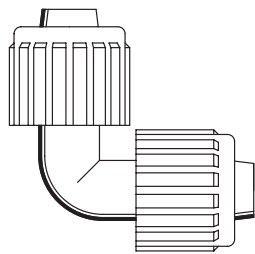

**Elbow w/ Male Flair-It Ends**

- D-4630** ELBOW 1/2" P x 1/2"P
- D-4632** ELBOW 3/4" P x 3/4"P

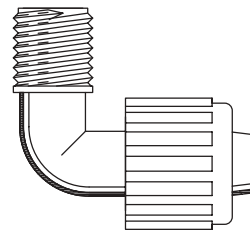

**Male Pipe Thread & Flair-It**

- D-4641** MALE ELBOW 1/2"P x 3/8" MPT

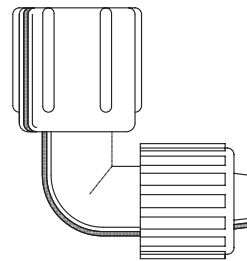

**Faucet Connection**

- D-4643** ELBOW 1/2" P x 1/2" FPT SWIVEL BSP

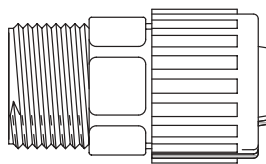

**Adapts w/Male Threads**

- D-4661** ADAPTER 1/2"P x 1/2" MPT
- D-4662** ADAPTER 1/2" x 3/4" MPT
- D-4664** ADAPTER 3/4" x 3/4" MPT

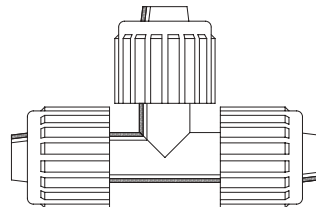

**Tees with 3 Flair-It Connections**

- D-4668** TEE 1/2"P x 1/2" P x 1/2"P
- D-4669** TEE 3/4"P x 3/4" P x 3/4"P
- D-4672** TEE 3/4" P x 3/4" P x 3/4"P
- D-4673** TEE 3/4" P x 1/2" P x 3/4"P

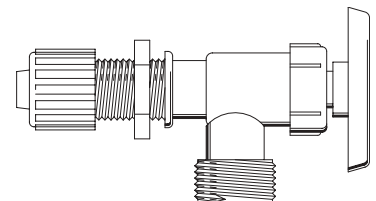

**Washing Machine Valve**

- D-4689** WASHING MACHINE BOX VALVE 1/2"P

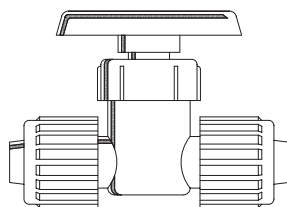

**Straight Stop valve**

- D-4691** STRAIGHT STOP VALVE 1/2" P x 1/2"P

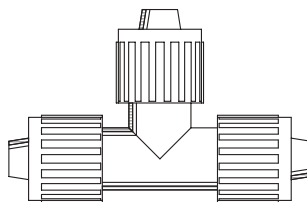

**Ice Maker Hookup Fittings**

- D-4697** ICE MAKER TEE WITHOUT VALVE 1/2" P x 1/2" P x 1/8"P

# Plumbing - Faucets

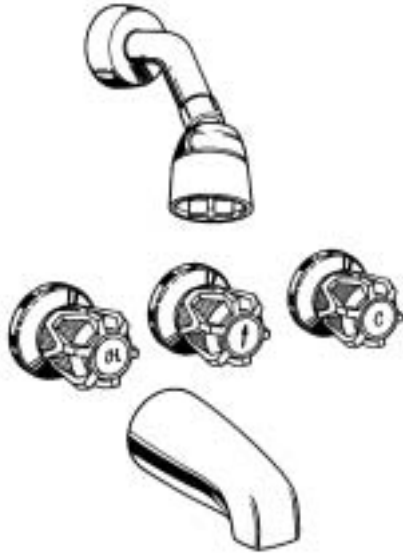

**B-2107** 8" THREE-VALVE DIVERTER



**B-2104** EXPOSED 2-VALVE SHOWER  
W/ARM & HEAD



**B-2103-P** 4" PLASTIC LAVATORY  
FAUCET LESS POP-UP

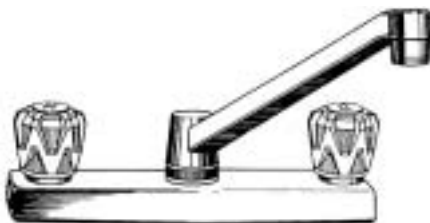

**B-2096** 8" PLASTIC SINK FAUCET W/S. SPOUT



**B-2101** 8" PLASTIC SINK FAUCET W/S. SPOUT

# Plumbing - Faucets

## Shower & Tub



**B-2111-C**

CONCEALED 2 VLV.  
SHOWER W/ HEAD



**B-2100-B** 1/2 SHOWER HEAD  
W/ARM&FLANGE



**B-2115** - 8" ADJ. BRASS  
GARDEN TUB FAUCET



**B-2109**  
8" TUB & SHOWER FAUCET  
W/HEAD FITTING STRAIGHT  
ACROSS



**B-2109-F**  
EXPOSED 2-VALVE SHOWER  
FITTINGS ARE OFFSET



**B-2111-E**  
EXPOSED 2-VALVE SHOWER  
W/HEAD

# Plumbing - Sinks / Misc.

## Kitchen & Bath



**B-2117** 33X19 STAIN.STEEL SINK W/LEDGE  
14" x 14" x 6-1/4"

NOTE: Cutout Size 32-1/4" x 18-1/4"



### CO Plug

**B-2139-P**

1-1/4" PLASTIC C.O.  
PLUG W/STOPPER

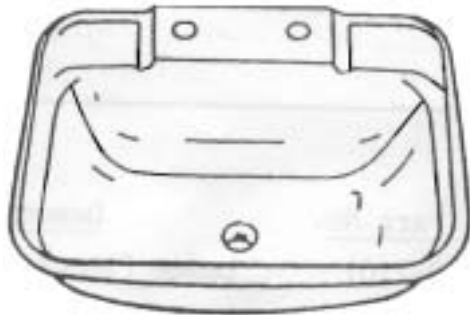

**B-6232-K** 17 X 20 BONE PLAS. LAV. RECTANGLE  
**B-6232-KW** 17 X 20 WHITE PLAS.LAV. RECTANGLE



### Basket Strainer

**B-2133-P**

PLASTIC 3-1/2"  
BASKET STRAINER



### Mobile Home Anti-Freeze

**B-2075-MH**  
MOBILE HOME  
ANTIFREEZE



### Adjustable Continuous Waste

**B-2126** 1-1/2" ABS CONTINUOUS WASTE

# Plumbing - Tubs

## Regular Tub

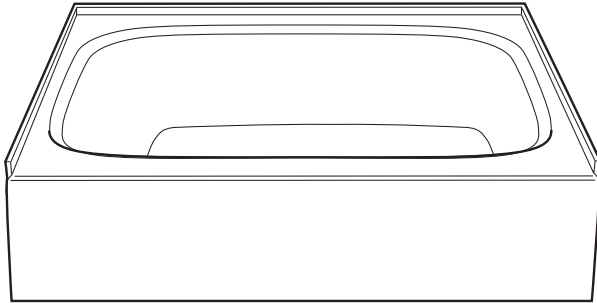

### Special Order

B-6182 27" X 54" WHITE TUB W/CENTER DRAIN

B-6183 27" X 54" IVORY TUB W/CENTER DRAIN

### Standard Tubs

B-6200 27" X 54" L.H. IVORY BATHTUB

B-6201 27" X 54" R.H. IVORY BATHTUB

B-6202 27" X 54" L.H. WHITE BATHTUB

B-6203 27" X 54" R.H. WHITE BATHTUB

## Roman Sunken Tub

### Special Order

B-6185 42" X 60" IVORY ROMAN TUB

B-6186 42" X 60" WHITE ROMAN TUB

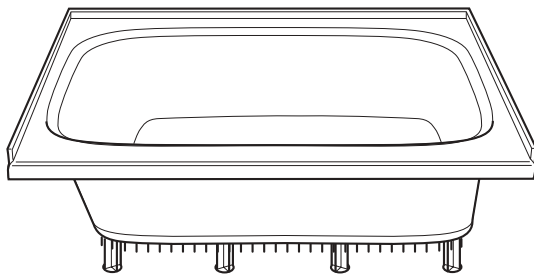
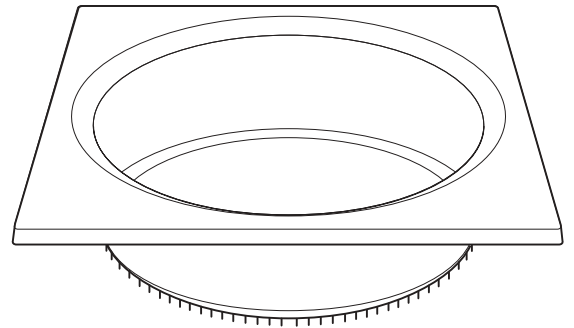

## Without Apron

### Special Order

B-6180-1 27" X 54" L.H. IVORY W/O APRON

B-6180-W 27" X 54" L.H. WHITE W/O APRON

B-6181-1 27" X 54" R.H. IVORY W/O APRON

B-6181-W 27" X 54" R.H. WHITE W/O APRON

## Garden Tub

B-6210 43" X 54" IVORY GARDEN TUB

B-6211 42" X 54" WHITE GARDEN TUB

B-6212 43" X 60" IVORY GARDEN TUB

B-6213 43" X 60" WHITE GARDEN TUB

B-6214 48" X 60" IVORY GARDEN TUB

B-6215 48" X 60" WHITE GARDEN TUB

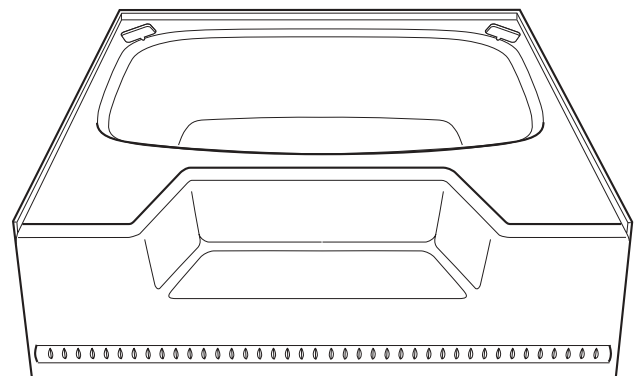

# Plumbing - Showers

## Doors & Shower Pans



### Shower Door

B-6206 32" SHOWER DOOR



**SPECIAL ORDER**

### Sliding Shower Door



**B-6207-P** 56" X 58" BATH ENCLOSURE

Silver satin anodized finished with safety tempered glass enclosure accents any bathroom. Nylon ball bearing rollers. W-type bottom track, wrap-around vinyl glazing and 2 single towel bars.

**Special Order**

### Shower Pans

(Handicap Accessible)



**Special Order**

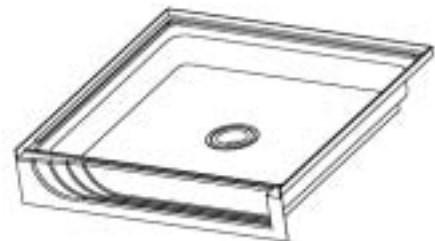

**B-6205** 32" X 32" SHOWER PAN IVORY

**B-6205-W** 32" X 32" SHOWER PAN WHITE

**B-61771** 27" X54" L.H. IVORY PVC SHOWER PAN

**B-6177-W** 27" X54" L.H. WHITE PVC SHOWER PAN

**B-6178-I** 27" X54" R.H. IVORY PVC SHOWER PAN

**B-6178-W** 27" X54" R.H. WHITE PVC SHOWER PAN

### Tub Moulding Kits



**B-6225** 10' TUB COVE

**B-6226** LEFT HAND END FOR TUB COVE

**B-6227** RIGHT HAND END FOR TUB COVE

**B-6228** CORNER FOR TUB COVE

**B-6229** 12' METAL INSIDE CORNER COVE

# Plumbing - Tubs & Showers

## Surrounds, Pans, Doors

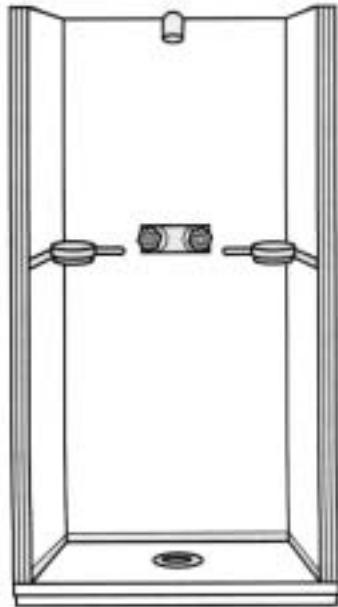

*32" x 32"  
Shower Pan  
& Surround*

**B-6204**  
COMPLETE  
(2 PC.) SHOWER  
STALL

**B-6204-W**  
COMPLETE  
(2 PC.) SHOWER  
STALL WHITE

**SPECIAL ORDER**

## Accessories



**B-2134**

3-1/2" FLAT SHOWER STRAINER

**B-2137**

REPLACEMENT DRAIN F/TUB

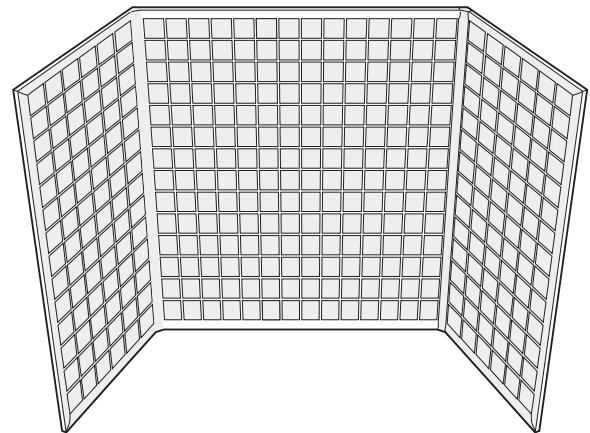

### *3 Piece Surround*

\* **B-6179-I** IVORY PVC WALL SURROUND

\* **B-6179-W** WHITE PVC WALL SURROUND

**B-6216** 27" X 54" X 60" IVORY TUBWALL

**B-6216-W** 27" X 54" X 60" WHITE TUB WALL

\* **B-6217** 43" X 54" X 60" H TUB WALL IVORY

\* **B-6217-W** 43" X 54" X 60" H TUB WALL WHITE

\* **B-6218** 43" X 60" X 60" H TUB WALL IVORY

\* **B-6218-W** 43" X 60" X 60" H TUB WALL WHITE

\* **B-6219** 48" X 60" X 60" H TUB WALL IVORY

\* **B-6219-W** 48" X 60" X 60" H TUB WALL WHITE

### *"Centra" BathTub Wall Kit*

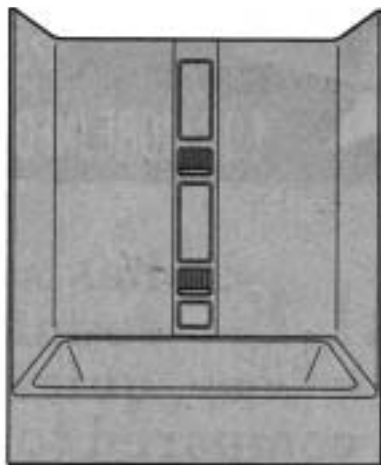

**B-6216-1** 1 PC. ALMOND TUB WALL

**B-6216-1W** 1 PC. WHITE TUB WALL

This do-it-yourself kit has a 1-piece flexible panel wraps around for seamless waterproof bath walls.

# Carpets & Flooring

## Plush Carpeting

- B-9600** 40 SQ. YRD. ROLL 1/2" REBOND CARPET PAD 3 1/2 LB.
- B-9601** 1/2" SHAVED FOAM CARPET PAD
- B-9602** 40 SQ. YRD. ROLL 3/8" REBOND CARPET PAD 3.5 LB.
- B-2993** CARPET HEAT SEAMING TAPE

### Plush 13' 7" Wide

- B-9521-13-BE** PLUSH - BURGANDY
- B-9521-13-BL** PLUSH - NATURE GREEN
- B-9521-13-BU** PLUSH - QUARRY BEIGE
- B-9521-13-GR** PLUSH - ROYAL NAVY
- \* **B-9521-13-BI** PLUSH - GRAY

### Plush 15' 3" Wide

- B-9521-15-BE** PLUSH - BURGANDY
- B-9521-15-BL** PLUSH - NATURE GREEN
- B-9521-15-BU** PLUSH - QUARRY BEIGE
- B-9521-15-GR** PLUSH - ROYAL NAVY
- \* **B-9521-15-GY** PLUSH - GRAY

\* Special Order



## Vinyl Flooring

- B-9561-NE** NEUTRAL DIAMOND VINYL
- B-9561-WO** WOODGRAIN DIAMOND VINYL
- B-9623** 25 LB. BAG PACKAGED FLOOR PATCH



- B-9623** 25 LB. BAG PACKAGED FLOOR PATCH



- B-9630** - TACK STRIP FOR CARPET



- B-9641** - 4" X 12' FLOOR SEAM BINDER



- B-9635** - 12' GOLD CARPET METAL



- B-9638** - 12' GOLD FLAT 1 1/2" METAL

# Lights & Fixtures

## Indoor & Outdoor



**B-6806**  
CLEAR  
GLASS  
PORCH LT  
W/GLOBE  
BASE  
**B-6742**  
BASE

- Black steel fixture with clear jelly jar glass
- Extends 5" from wall



Proj. 5" Dia. 12" White Plastic diffuser, 2 60W bulbs

**B-6740**  
BASE ONLY F/B-6750-52-53  
**B-6750**  
WHITE ROUND 12" DIA. - 5"  
DROP LT.



**B-6813** WHITE PLASTIC SHADE 12" DIA.

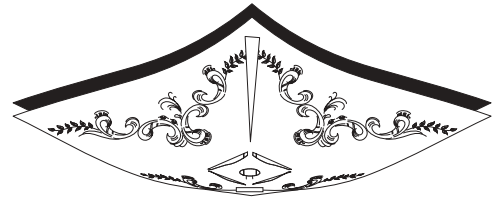

**B-6814** WHITE 11 3/4 SQ. GLASS SHADE  
**B-6740** BASE

### Indoor Wheat Design Ceiling Light Fixture

- White square glass fixture has a clear wheat design. White mount blends well with ceiling color. Uses two 60W bulbs (net included)

### Power Supply Cords

50 AMP Mobile Home Life Line

Heavy duty. Color coded lead wires with molded-on four-prong plug on one end. Three No. 6 wires and one No. 8 wire.



**B-2589** 50 AMP 36' POWER SUPPLY CORD  
**B-2590** 50 AMP 25' POWER SUPPLY CORD

## Evaporative Cooler

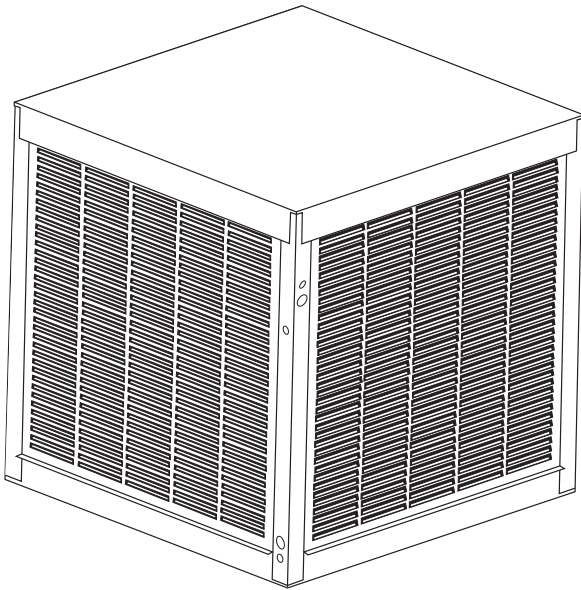

### CABLE TIES

**B-7024** CLAMP FOR 12" FLEX DUCT NATURAL NYLON



### Flex Duct

**B-7025** 12" X 25' FLEX DUCT  
**B-7028** 14" X 25' FLEX DUCT  
**B-7030** 10" X 25' FLEX DUCT



**D-4312** AIR CONDITIONING BRASS ADAPTER

### Evaporative Cooler

**B-7900-35** 3500 CFM COOLER CABINET  
**B-7900-45** 4500 CFM COOLER CABINET  
**B-7900-48** 4800 CFM COOLER CABINET  
**B-7900-55** 5500 CFM COOLER CABINET  
**B-7900-65** 6500 CFM COOLER CABINET

**B-7901** COOLER TOP VALVE ASSEMBLY  
**B-7902** COOLER MOUNTING LEG KIT  
**B-7903** COOLER ROOF JACK & HANGER GRILL  
**B-7904** GRILL KIT  
**B-7905** INSTALLATION KIT  
**B-7906** COOLER COVER  
**B-7907** FLANGE KIT

**B-7908** 1/3 H.P. 2-SPEED MOTOR  
**B-7909** 1/2 H.P. 2-SPEED MOTOR  
**B-7910** 3/4 H.P. 2-SPEED MOTOR

Stocked at Albuquerque, New Mexico only.

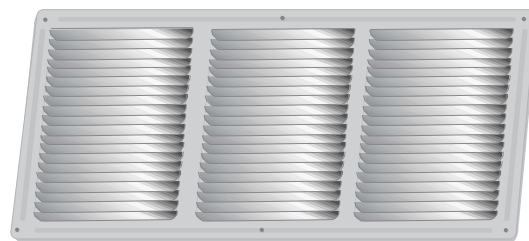

### Side Return Filter Grill

**B-2974** 16" X 4" AIR VENT W/SCREEN  
**B-2975** 16" X 8" AIR VENT W/SCREEN

Large, easy-to-clean swept back fins 22-Degress to conceal filter. One-piece, heavy gauge steel multi-louvered damper for both heating.

# HVAC

## Floor Registers

Especially designed and engineered by Nordyne for all manufactured home applications. With special attention given to the elimination of air flow restriction, these modern registers and grills allow for maximum air circulation for both heating and cooling.

### State of the art features that save you time and money.

- Engineered to provide properly directed maximum air flow for heating and cooling.
- Oversized flange allows for fast and simple installation.
- Designed with narrow shutters to avoid blocking air flow through the duct system.
- Louvers of heavy gauge steel to prevent bending are closely spaced to prevent small objects or high heels from going through – completely safe.
- Coated with maintenance-free abrasive resistant enamel finish. Positive 100% closing on registers.
- Register operating device extends only 1/16" above the top of the register. May be either hand or foot adjusted.

### DIMENSIONS (INCHES)

DIM.	REGISTER		
	4X8	4X10	4X12
A	7 <sup>9</sup> / <sub>16</sub>	9 <sup>7</sup> / <sub>8</sub>	11 <sup>1</sup> / <sub>2</sub>
B	8 <sup>7</sup> / <sub>8</sub>	10 <sup>7</sup> / <sub>8</sub>	12 <sup>15</sup> / <sub>16</sub>
C	10	12	14
D	3 <sup>1</sup> / <sub>8</sub>	3 <sup>9</sup> / <sub>16</sub>	3 <sup>1</sup> / <sub>4</sub>
E	5 <sup>3</sup> / <sub>16</sub>	5 <sup>3</sup> / <sub>16</sub>	5 <sup>3</sup> / <sub>16</sub>
F	7 <sup>3</sup> / <sub>4</sub>	9 <sup>3</sup> / <sub>4</sub>	11 <sup>3</sup> / <sub>4</sub>
G	1	1	1
H	3/4	3/4	3/4
J	3 <sup>1</sup> / <sub>2</sub>	3 <sup>1</sup> / <sub>2</sub>	3 <sup>1</sup> / <sub>2</sub>
K	1 <sup>1</sup> / <sub>8</sub>	1 <sup>1</sup> / <sub>8</sub>	1 <sup>1</sup> / <sub>8</sub>

**B-2977** 4" X 10" FLOOR REGISTER"  
**B-2977-WH** 4" X 10" WHITE FLOOR REGISTER

LARGER SIZES AVAILABLE

**B-2976** 4" X 8" FLOOR REGISTER"  
**B-2976-WH** 4" X 8" WHITE FLOOR REGISTER

LARGER SIZES AVAILABLE

**B-2978** 4" X 12" FLOOR REGISTER"  
**B-2978-WH** 4" X 12" WHITE FLOOR REGISTER

LARGER SIZES AVAILABLE

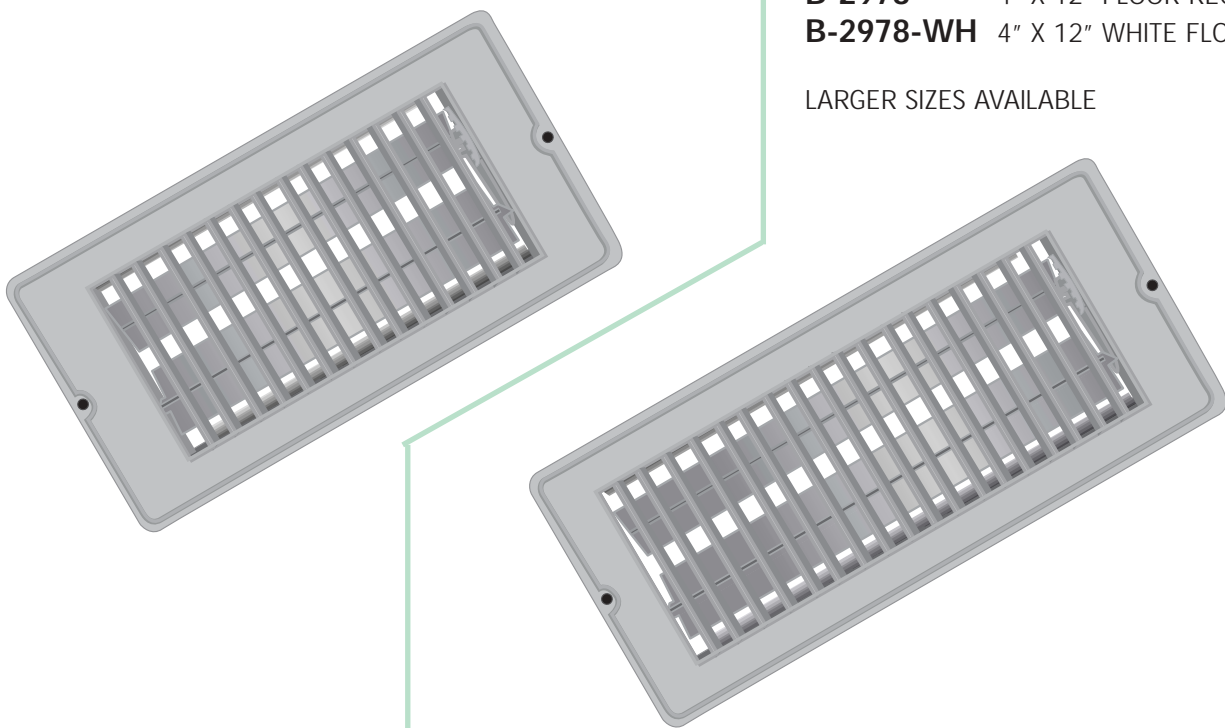

# Roofing

## Roof Coating Products



**B-6004** 5GAL. M.H. WHITE  
ROOF COATING



**B-6012** 5GAL. M.H. WHITE  
ROOF COATING



**B-6021** 5GAL. KOOL TOP  
ROOF COATING

# Moldings

## Battens

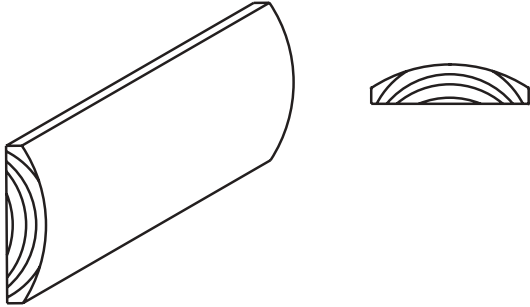

**B-9101-1**  
**B-9101-W-1**

1"LT.BROWN BATTEN (SGL.)  
1" WHITE BATTEN (SGL.)

# Moldings

## Casing

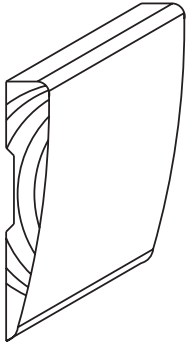

- B-9116-1** 2 1/8"LT.BRN.WOOD CASING(SGL.)
- B-9116-W-1** 2 1/8"WH.WOOD CASING (SGL.)

---

## Lips

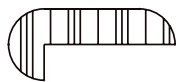
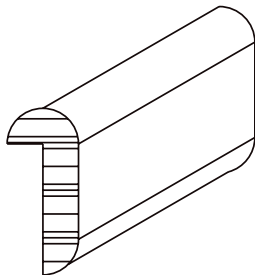

- B-9123-1** 15/16"LT. BROWN LIP (SGL.)
- B-9123-W-1** 15/16" WHITE LIP (SGL.)

# Moldings

## IS Corner

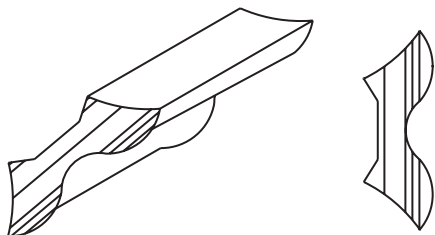

- B-9118-1** 1" LT.BROWN I.S.C. (SGL.)
- B-9118-W-1** 1" WHITE I.S.C. (SGL.)

---

## OS Corner

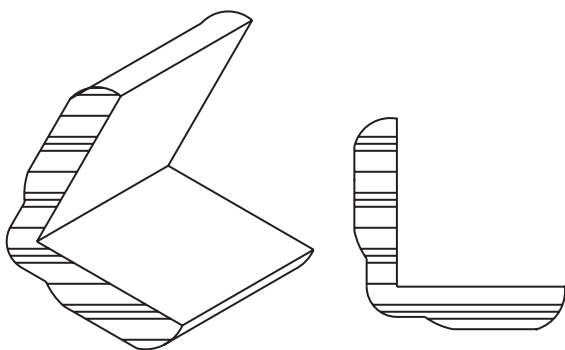

- B-9126-1** 15/16"LT.BROWN O.S.C.(SGL.)
- B-9126-W-1** 15/16"WHITE O.S.C. (SGL.)

# Moldings

## Shoes

**B-9110-1** 3/4"LT.BROWN SHOE (SGL.)  
**B-9110-W-1** 3/4" WHITE SHOE (SGL.)

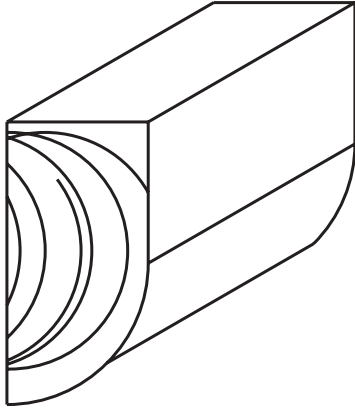

# Tape / Screws

## Plastic Rosette Washers



### Putty Tape

30' Rolls

**B-2986** 30' x 3/4"

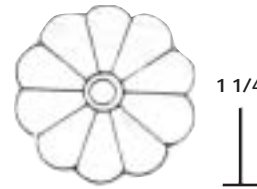

For fastening ceiling board.  
Center hole for No. 6 screw.

**E-5055**

1" DIAMETER WHITE ROSETTES

**E-5055-SS**

1-1/2" SCREW STAINLESS HEAD

### Nut Setter

**E-5182** 1/4"HEX MAG.NUT SET  
2"NOSE



Magnetic. For driving hex headed screws.



**B-2985** DUCT TAPE 2" X 60  
YARDS

### Rosette/Tub Trim Screws



**E-5031**

12/PKG.BRN.SCR.F/FLR.REGISTER

**E-5031-WH**

12/PKG.WH.SCREW F/FLR REGISTER

**E-5032**

100/PKG.BRN.SCR.F/FLR.REGISTER

**E-5032-WH**

100/PKG.WHITE SCR.F/FLR.REGISTER

### Black Bottom Board Tape



**B-6490**  
2" X 60 YD.  
BLACK BELLY TAPE

Specifically made for  
patching and splicing bottom  
board paper used in mobile  
homes. Certified to meet the  
HUD specification of the  
Office of Mobile Home  
Standards.

### Brass Hinge Screws



**B-6375-S**

PHILLIP BRASS  
HINGE SCREW



### Hex Head Screws

**E-5015**

50/PKG 8" X 1-1/2" HEX HD.SCREW

**E-5015-WH**

50/PKG. 8" X 1-1/2" WH.HEX HD.SCRW

**E-5025**

1000/CTN 8" X 3/4" HEX HEAD SCREW

**E-5027**

1000/CTN. 8" X 1-1/2" HEX HD.SCREW

**E-5027-WH**

1000/CTN. 8" X 1-1/2" WH.HEX HD.SC

**E-5028**

1000/CTN. 8" X 1 1/4" HEX HD. SCREW

**E-5028-WH**

1000/CTN. 8" X 1 1/4" WH.HEX HD. SCREW

# Sealants



## Professional Grade Painters Acrylic Latex Caulk

**B-2392**  
PAINTER'S 7 YEAR LATEX CAULK

### Premium Qualities

- Flexible
- Paintable
- Good Adhesion
- Non-Sagging
- Freeze Thaw Stable
- Energy Saver
- Mildew Resistant

### Ideal For:

Caulking window and door frames, baseboards, trim, siding corner joints, electrical boxes, pipe entries, outdoor faucets and around air conditioning.



Geocel 2300 Tripolymer Sealant is a single component, high-performance elastomeric sealant for use in a wide variety of roofing, window, door, siding, trim, architectural metal, automotive, manufacturing and general construction applications.



- B-2381** 11 OZ. GEOCEL CLEAR SEALANT
- B-2382** QT. GEOCEL CLEAR SEALANT
- B-2382-G** GAL. CLEAR GEOCEL SEALANT

## SUPER DUTY TRIM ADHESIVE

A fast drying, super strength spray adhesive for bonding carpets, jute pads, insulation, and other applications where a high strength adhesive is required. Adjustable spray valve allows the spray pattern to be adjusted to fit the application.



- B-2383** 15 3/4 OZ. HEAVY DUTY ADHESIVE

## CONSTRUCTION ADHESIVE

NOTE: For use with all types of material, ABS Plastic, wood, PVC, and Foam Insulation

### 117 PANEL & CONSTRUCTION ADHESIVE MULTI-PURPOSE

This ultimate all-around multi-purpose construction adhesive for homeowner and contractor use. This versatile product is a high-strength, rubber based adhesive for installing paneling, plywood and other wallboard panels, as well as foam insulation, furring strips, moldings, wall decorations and ceramic tile. Light colored, non-staining, waterproof. Resistant to severe temperature changes. Meets specifications ASTM C-557-65T, BOCA 73-36, and HUD/FHA. Extremely Flammable.

**Materials:** Paneling • Plywood • Gypsum Drywall • Wallboard • Foam Insulation • Furring Strips • Moldings • Subflooring • Ceramic Tile. Bonds firmly to dry concrete and clean metal.

- B-2391** PANEL & CONSTRUCTION ADHESIVE

### Premium Qualities

- Good Adhesion
- Elastic, Flexible
- Pliable
- Non-yellowing
- Paintable
- Mildew Resistant
- Ease of Use
- Freeze - Thaw Stable
- Air Free/Product
- Vacuumed



- B-2393-C** ALL-IN-ONE CLEAR SILICON CAULK

# Safety & Promo

## Safety



**B-2045** HOME FIRE SAFETY KIT



**B-2646**

ELECTRIC SMOKE ALARM

**B-2647**

SMOKE ALARM W/ 9V BATTERY  
BACK-UP

### Handy Hints on Smoke Detectors:

1. For best safety, have at least two smoke detectors. Place one near the kitchen, the other near the bedrooms.
2. Make it a habit to check your batteries regularly.

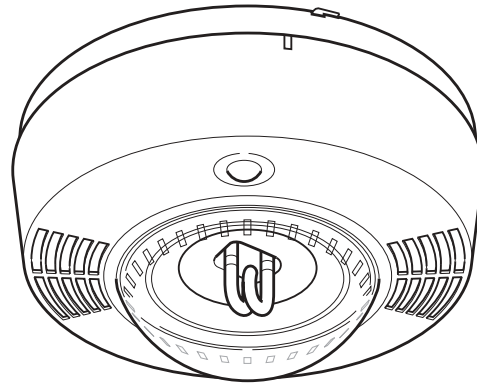

**B-2648**

ELECTRIC SMOKE DETECTOR W/ 9V  
BATTERY BACK-UP

## Carbon Monoxide Detector



**B-6052**

9V DETECTOR F/CARBON MONOXIDE